

V-Twin Mfg.
FXD FOOTBOARD KIT
For use on 1996-up FXD Models
VT No. 27-0920

This is a custom application and rider safety depends on proper installation. This product should only be installed by a knowledgeable and trained motorcycle technician. V-Twin Mfg. accepts no responsibility for improper installation.

FXD FOOTBOARD KIT - The V-Twin FXD Footboard Kit is designed for use on all 1996-up FXD models and includes all parts required to upgrade your mid or forward controls to touring style footboards for rider comfort.

Installation

Shifter Assembly (Left side)

1. Remove highway footrest assembly and or forward controls depending on model. Discard bracket, plate and mounting hardware.
2. Remove stock footrest assembly.
3. Remove stock shift lever and shifter rod.
4. On models with mid controls loosen the left rear crankcase bolt (at bottom of cylinder) and slide the slotted end of shift lever retainer bracket (10) under the head of the bolt. Do not tighten bolt at this time. **Note:** There are two different brackets included in this kit. The 21-0768 is for use on 2006-09 models and the 21-0766 is for use on 1996-05 models. Bracket 21-0768 is shown in photo # 3 below.
5. Bolt mid shift lever retainer bracket (10 or 2 depending on model year) to the stock shift lever with bolt (1). On 2006 and later models the bolt will have to come in from the right side. On 2005 and earlier models it will go in from the left side. Be sure to use blue loctite. Note the difference in bracket orientation for Evolution and Twin-Cam 88 models. Tighten crankcase bolt to 15-17 ft-lbs.
6. Place chrome shaft cover (11) over shifter shaft (6) between shift lever and footboard-shift bracket (19). Coat shaft with Anti-seize and slide into bracket (19).
7. Place small wave washer (12) on shift lever shaft (6) between shift lever and footboard-shift bracket (19). Coat shaft with Anti-seize and slide into bracket (19).
8. Install footboard-shift bracket (19) using bolts (3) and washer (27). Tighten screws to 25-30 ft-lbs.
9. Place shift rod (7) in position. Use long stud on shift rod to secure shift rod at the transmission end. Use blue Loctite on stud before installing.
10. Insert the other end of the shifter rod (short stud) through shift lever. Install washer (26) and acorn nut (30) and secure. Use blue Loctite on stud before installing.
11. Install heal toe shift lever (8). Tighten retaining bolt (16).
12. Install shifter pegs (10) onto heal toe shifter lever. Use Red loctite on shift peg studs.
13. Mount Left rear footboard bracket (20) to frame using supplied hardware (3 & 27). See photo # 2 below. Tighten bolts to 25-30 ft-lbs.
14. Install footboard using supplied hardware (22 & 29).

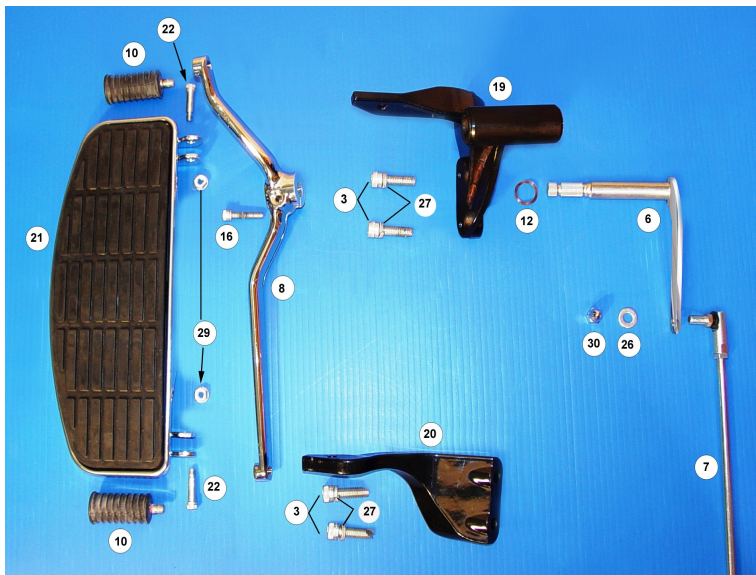

Photo # 1



Photo # 2

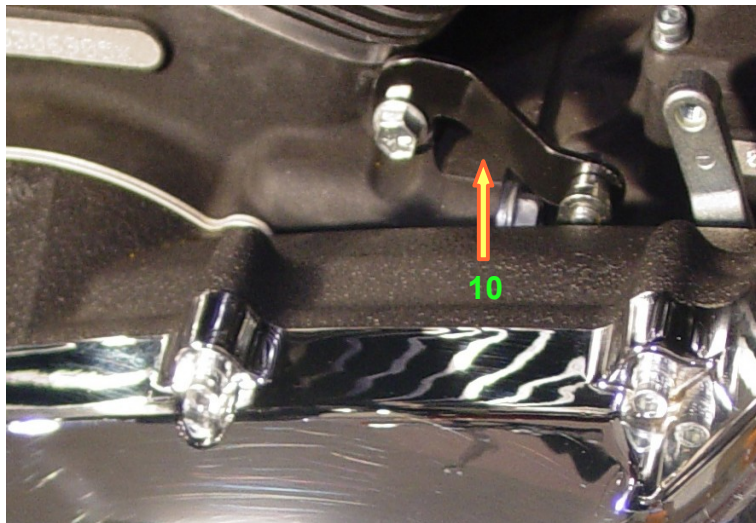

Photo # 3

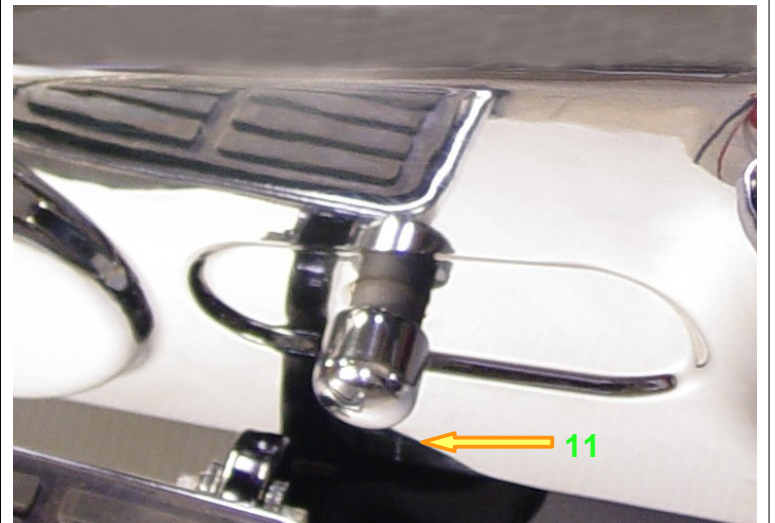

Photo # 4

