

VT No. 12-9921

PRO-JUST INSTALLATION

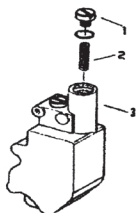

1. Remove the stock pressure relief cap. #1
2. Remove the stock pressure relief spring. #2
3. Install the blue “Superpump” spring.
4. Replace the stock cap with the Pro-Just

DO NOT OVER TIGHTEN THE PRO-JUST A SNUG FIT IS FINE

USE OF VISE GRIPS VOIDS ALL WARRANTIES

OEM OIL PRESSURE SPECS

Cold start up: up to 44psi

At warm idle: at least 10 psi

Warm engine 55mph and up: 30 to36 psi



1/8" setting

- * Do Not adjust above the neutral 1/8” position
- * 1/8” setting is the neutral position - which is from the top of the Pro-Just body to the bottom of the thumbscrew
- * The Pro-Just is shipped in the neutral position

Important Notes

Adjustment of the Pro-Just is done with the engine running.

Adjustment is always down

Turning the adjusting screw clockwise increases the oil pressure.

Turning counter clockwise decreases oil pressure.

Do Not adjust above the 1/8” neutral position.

If your oil pressure reads 0 psi before and after installing the Pro-Just, please check your pump for any broken keys or foreign matter.