



Instruction Sheet For #1045-TS

TIMKEN BEARING REMOVER Use on Big Twin 1955-Present



Use to remove Timken® bearing from sprocket shaft without removing shaft from flywheels (CAUTION: On 1986-present, H.D.® flywheels, you may need to modify left flywheel to install tool behind bearing).

1. Refer to H.D.® Service Manual for disassembling crankcase, and use JIMS® tools #1006T motor stand, and tool #1047-TP flywheel press.
2. With flywheels installed on JIMS® #1071, flywheel rebuilding jig, sprocket shaft facing up and clamped tight in vice.
3. Install the two halves, #1045-TS-1, with pulling edge under the bearing. Slip ring #1045-TS-2 over the two halves.
4. Lube the threads of bolts, #2012, slip one washer, #2014, over each bolt. Align puller bar over the bolt holes in top of the two halves, thread in both bolts the same amount as far in as possible.
5. Lube threads and tip of screw, #1024, thread through puller bar until bearing is pulled from sprocket shaft.

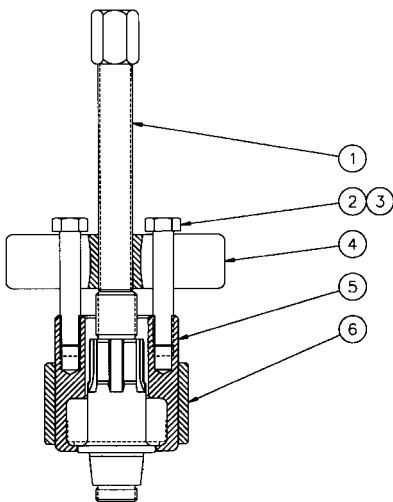

PARTS AVAILABLE SEPARATELY

No.	Qty.	Description	Part No.
5	1	BEARING HOLDER - TWO HALVES	1045-TS-1
6	1	RING	1045-TS-2
2	2	BOLT	2007
4	1	PULLER BAR	2013
3	2	FLAT WASHER	2014
1	1	SCREW	1024

CAUTION: Wear safety glasses, Excessive force may damage parts or tools.

"From the Track... To the Street!"

555 Dawson Drive, Camarillo, CA 93012
Phone 805-482-6913 • Fax 805-482-7422