



# Instruction Sheet For #97225-55

## Sprocket Shaft Bearing Installation Tool

Use on Big Twin 1955-Present



1. Refer to H.D.® Service Manual for specifications. *NOTE: Do not use impact tools on any flywheel assembly tool. Damage will occur to flywheels, bearings, body and tools.*
2. With flywheel all ready to go into left case, mounted in JIMS® tool #1071 flywheel rebuilding jig, and clamped in vice.
3. Lube sprocket shaft bearing area, with JIMS® #2124 Press Fit Lube, and I.D. of bearings.
4. Install the bearing over sprocket shaft and spacer #24036-70 (may need spacer with bearing tool just for the first bearing).
5. Lube main body #1 I.D. and O.D. threads. Thread main body onto sprocket shaft with handle #4 as far as possible.
6. Slip slider #3 over main body #1, next install lubed bearing and washer #5. With bearing in between the two washers thread nut assembly #2 onto main body and tighten until bearing bottoms on shaft shoulder using JIMS® tool 94660-37A, and torque to H.D. specification.
7. Remove nut assembly #2, slider #3, washer and bearings #5 and spacer #24036-70, and install left case.
8. Slip bearing inner spacer and bearing over sprocket shaft, followed by slider #3 and bearing and washer #5, thread on nut assembly #2 and tighten. See H.D.® Service Manual for end play and torque specifications.
9. See JIMS® tool #39361-69 for installing motor seal with this tool.

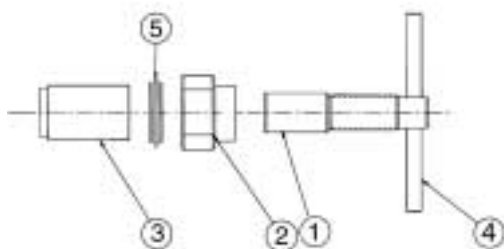

### PARTS AVAILABLE SEPARATELY

No.	Qty.	Description	Part No.
1	1	MAIN BODY	97225-55-1
2	1	NUT/HANDLE ASSEMBLY	1026-B
3	1	SLIDER	97225-55-3
4	1	LONG HANDLE	1028
5	1	BEARING & WASHER	1047-54

**CAUTION:** Wear safety glasses. Excessive force may damage parts! See JIMS® catalog for over 100 other top quality professional tools. The last tools you will ever need to buy.

*"From the Track... To the Street!"*

555 Dawson Drive, Camarillo, CA 93012 • Phone 805-482-6913 • Fax 805-482-7422