

VT No. 18-0677

1. Position the motorcycle upright on a stand or jack.
2. Remove the clutch cover.
3. See the service manual and Figure 2. Add freeplay to the clutch cable until the adjuster is fully collapsed.
 - a. Slide rubber boot (1) off cable adjuster.
 - b. Hold cable adjuster (2) and loosen jamnut (3).
 - c. Turn cable adjuster until the clutch adjuster is fully collapsed.
4. Adjust the clutch adjuster screw (2) with the stock retainer spring in place.
 - a. Turn the screw in until it gently bottoms out.
 - b. Turn the screw out 1/2 to 1 turn.
5. Loosen 6 screws (3) a little at a time and carefully remove the diaphragm spring retainer (4).
6. See Figure 7. Bend the tabs of the base plate (2) slightly to match the angle of diaphragm spring.
7. See Figure 4. Starting with the widest tab on the baseplate, insert it inside the diaphragm spring. Check to make sure that it is fully seated.
8. See Figure 5. Starting with one of the bottom levers, install the variable pressure clutch.
9. See Figure 5 and Figure 7. Secure the variable clutch.
 - a. Start installing each of the bolts (3) and washers (4) included in the kit.
 - b. Tighten each bolt to just snug.
 - c. Check that the diaphragm spring is in the proper position.
 - d. In an alternating pattern, tighten each bolt to 10.2–12.4 N·m (90–110 in-lbs).
10. See the service manual and Figure 6. Adjust the clutch cable (1) and allow at least 3.1 mm (1/8 in) of free play (4).

NOTE

If an accessory clutch cover is installed, it may not provide adequate clearance over the new clutch plate.

11. Install clutch cover, seal and screws. Alternately tighten screws to 9.5–12.2 N·m (84–108 in-lbs).

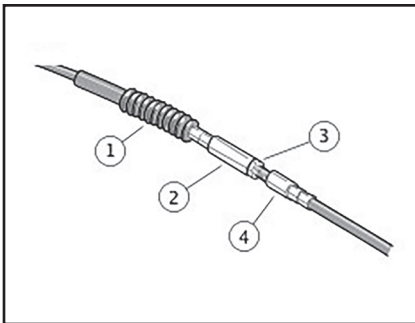

Figure 2. Clutch Cable Adjuster

- 1 Rubber boot
- 2 Cable adjuster
- 3 Jamnut
- 4 Cable end

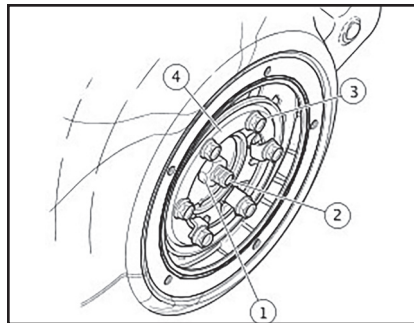

Figure 3. Clutch Adjuster Screw and Diaphragm Spring Retainer

- 1 Jamnut
- 2 Clutch adjuster screw
- 3 Screw (6)
- 4 Diaphragm spring retainer

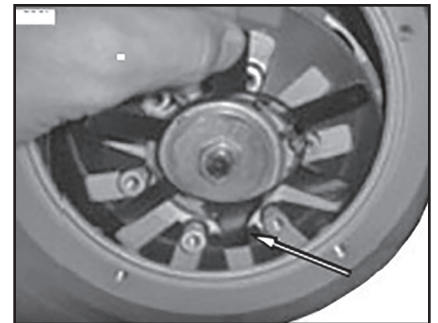

Figure 4. Install Base Plate

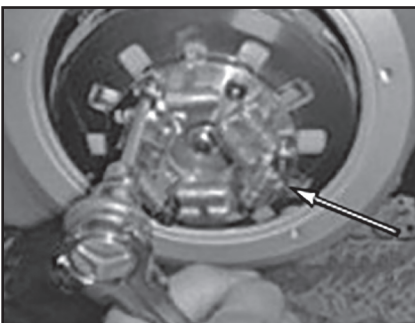

Figure 5. Install Variable Pressure Clutch

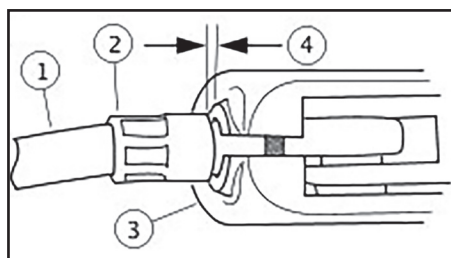

Figure 6. Clutch Cable Free Play

- 1 Clutch cable
- 2 Cable ferrule
- 3 Clutch lever bracket
- 4 Free play: 1/8 in. (3.1 mm)

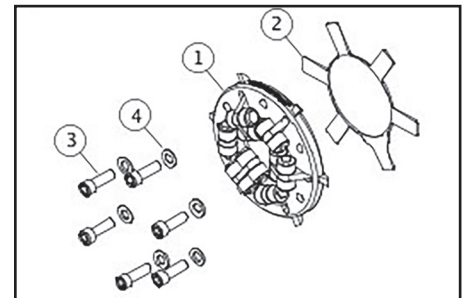

Figure 7. Variable Pressure Clutch

- 1 Clutch cable
- 2 Cable ferrule
- 3 Clutch lever bracket
- 4 Free play: 1/8 in. (3.1 mm)