

V-Twin Mfg.
Chrome Belt Guard and Pulley Cover Kit
VT Part No. 27-0619

This is a custom application and rider safety depends on proper installation. This product should only be installed by a knowledgeable and trained motorcycle technician. V-Twin Mfg. accepts no responsibility for improper installation.

Lower Belt Guard Installation Instructions:

1. Remove the three screws with captive washers (3) securing the original equipment lower belt guard (debris deflector, Item 1) to the underside of the rear fork (2), and set them aside for re-use. Remove and discard the lower belt guard.
2. Position the new chrome lower belt guard in place on the underside of the rear fork, lining up the three holes in the belt guard with the mounting holes in the fork. Insert the three screws saved earlier through the holes in the belt guard, and thread them into the fork. Tighten the screws to 36-60 in-lbs.

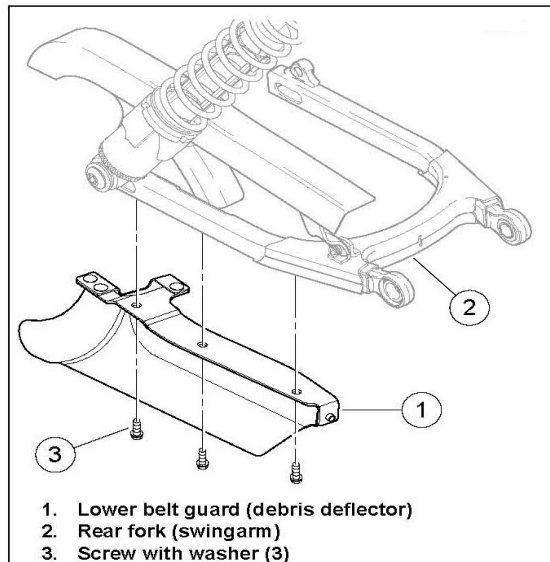

Rear Chrome Sprocket Cover Installation Instructions

1. Follow the procedure found in the Service Manual to remove the rear wheel assembly from the motorcycle.
2. Remove the five sprocket mounting screws.

Note: Apply red Loctite to each screw before installing.

3. Position the sprocket cover over the sprocket. Install the sprocket cover using the five screws removed in step 2.

Note: If you are replacing the original equipment sprocket mounting screws with Chrome Hardware Kit refer to the instructions listed below. If not go directly to step four.

For 1997 and Later XL with Laced Wheels

For 1997 through 1999 Softail with Laced Wheels

For 1998 through 1999 Dyna with Laced Wheels

For ALL Models with Cast Wheels

- A) Remove the rear wheel. Refer to REAR WHEEL REMOVAL in the Service Manual.
- B) Remove all stock sprocket mounting screws and washers.
- C) Place a new chrome washer onto the threads of each new chrome screw from the kit. Apply 2-3 drops of Loctite 262 (red) to the screw threads, and install the sprocket onto the wheel. Tighten all sprocket screws finger-tight.
- D) Tighten the bolts in the sequence shown to 23 ft-lbs.
- E) If 23 ft-lbs is reached before screw is fully seated, remove screw and examine screw and wheel for thread damage. Replace screw or wheel if threads are damaged.
- F) After all screws have been tightened to 23 ft-lbs. mark a straight line, with a grease pencil, on all sprocket screw heads continuing the line over onto the sprocket.
- G) Mark a second line at 30° clockwise from the lines on the sprocket at each screw.

Note: For best results, use Snap-on Torque Angle Gauge TA360 or equivalent.

- H) Using the marks as a guide, and using the tightening sequence shown in photo below. Turn each screw an additional 1/12 turn or 30° clockwise.
- I) Install the rear wheel. See REAR WHEEL INSTALLATION in the service manual. Verify the correct axle alignment and check belt deflection per service manual instructions.

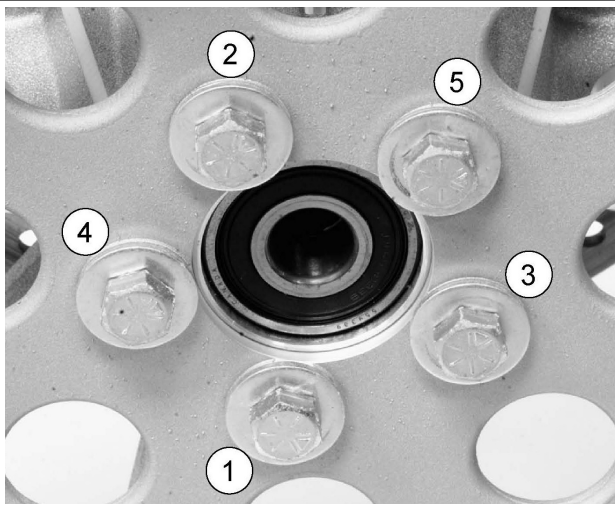

**Tightening Sequence
(Earlier Laced Wheels)**

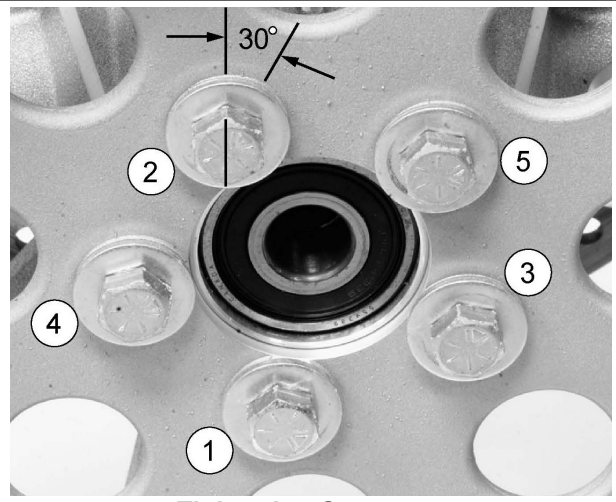

**Tightening Sequence
(Later Laced Wheels and All Cast Wheels)**

4. Consult the Service Manual for your model motorcycle and wheel type for the correct torque values.
5. Follow the procedure found in the Service Manual to install rear wheel assembly on the motorcycle.

XL Upper Belt Guard Installation Instructions:

Removal

1. Un-thread right side lower shock absorber mount nut (3). Pull shock absorber mounting bolt (1) out slightly until it clears mounting tab hole in belt guard (7) but do not remove completely. Save nut for re installation.
2. At the front of the belt guard, remove bolt (6), washer (5) and nut (4). Save hardware for re installation.
3. Remove belt guard from vehicle.

Installation

Note: When installing the new chrome belt guard, the front mounting tab (8) attaches to the outside of the swing arm mounting tab (9). The rear belt guard mounting tab (10) attaches to the inside of the shock absorber mount tab (11).

1. Slide new belt guard (7) into place on vehicle.
2. Secure front of belt guard to rear swing arm with bolt (6), washer (5) and nut (4). Tighten to 120-180 in-lbs.
3. Push lower shock absorber mounting bolt (1) through belt guard mounting hole. Thread nut (3) on bolt. Tighten to 45-50 ft-lbs.

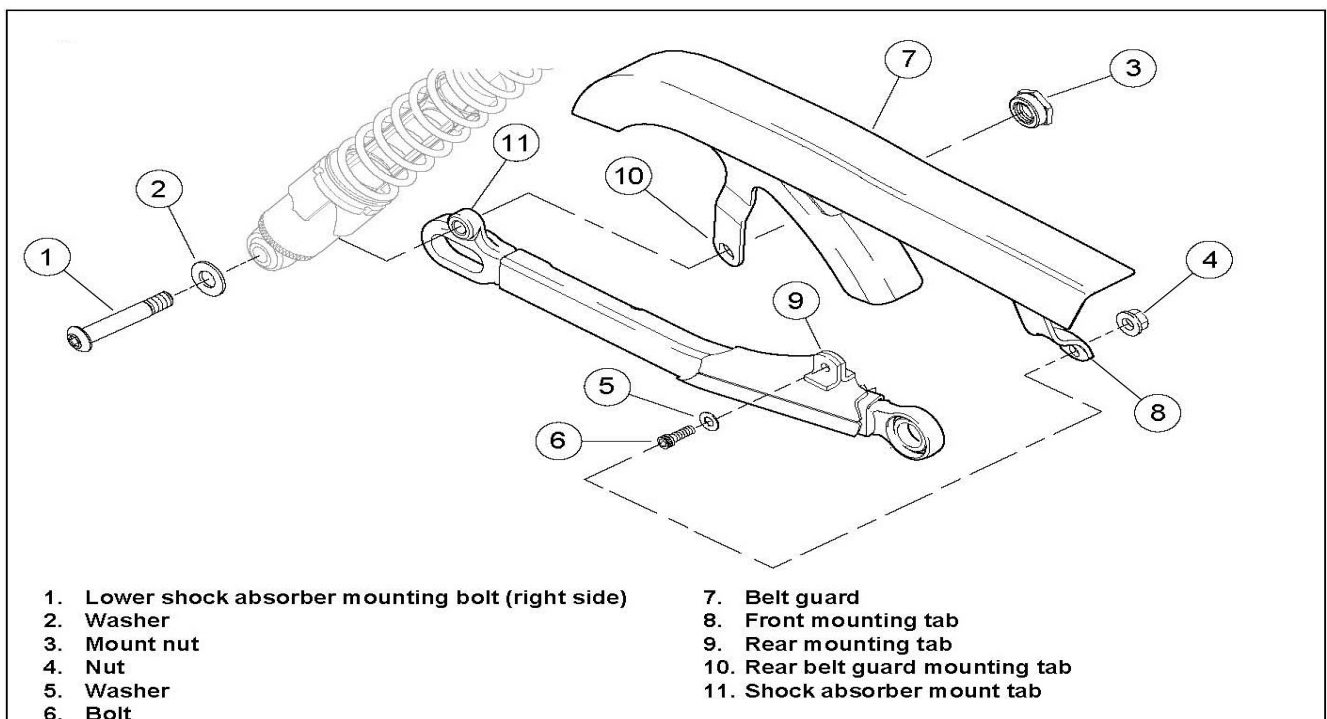

Upper Belt Guard Removal and Installation