

1991-95 Dyna Solo Seat Kit VT No. 31-0087

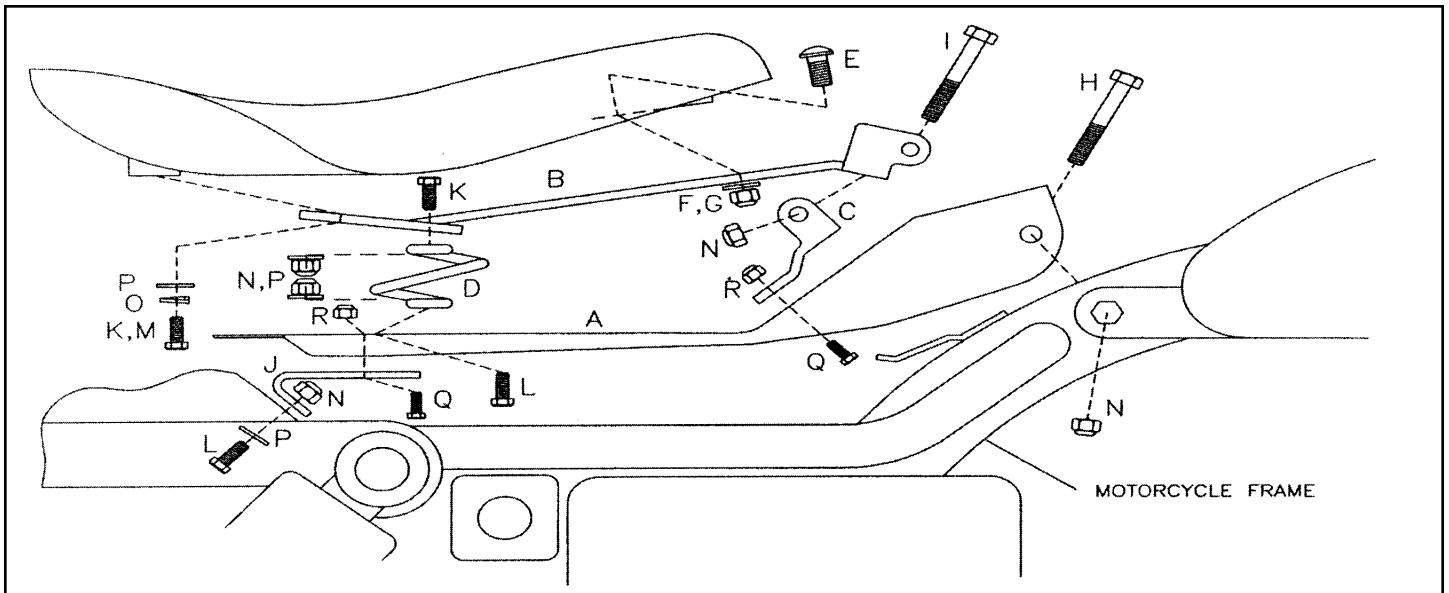

Assembly Instructions

1. Attach the hinge to the cover with the screws and nuts as shown.
2. Attach the springs to the cover with the screws, nuts and washers as shown.
3. Attach the seat "T" to the springs and hinge with the screws, nuts and washers as shown.
4. Attach the cover and seat "T" assembly to the motorcycle frame and fender with fender bracket, screws and nuts as shown.
5. The seat "T" will accept mount solo seats sold separately. Hardware is provided in the kit to mount solo seats.

Parts List

Qty	VT No.	Item Description
1	42-0981	Frame Cover (A)
1	31-0892	Seat "T" (B)
1	31-0015	Front Bracket (C)
1pr	13-0742	1" Springs (D)
1		3/8-16 NC x 1 Carriage Screw (E)
1		3/8-16 NC Nyloc Nut (F)
1		3/8 NC Flat Washer (G)
1		5/16-18 NC x 3-1/2 Hex Head Screw (H)
1		5/16-18 NC x 2-1/4 Hex Head Screw (I)
1		Fender Bracket (J)
2		5/16-18 NC x 3/4 Hex Head Screw (K)
3		5/16-18 NC x 5/8 Hex Head Screw (L)
2		5/16-24 NF x 3/4 Hex Head Screw (M)
5		5/16-18 NC Nyloc Nut (N)
2		5/16 Split Lock Washer (O)
7		5/16 Flat Washer (P)
4		1/4-20NC x 5/8 Hex Head Screw (Q)
4		1/4-20NC Nyloc Nut (R)
2		5/16-18 Jam Nyloc
2		5/16-18 x 3/4 Flat Head Allen Screw