

ITEM	NUMBER USED	PART NUMBER	NAME
1	1	2764-30	Switch Key (specify letter and number of lock)
2	1	4529-36A	Switch cover
3	1	4548-36	Switch Lock
4	1	4536-36	Switch Housing
5	1	4554-36	Switch Lock Plate
6	1	4543-36	Center Pin
7	1	Contact Bar Holder Assembly
8	1	Reinforcing Plate
9	1	4539-36	Contact Plate
10	1	4541-36	Contact Bar
11	4527-36	Ignition-Light Switch Assembly (shown as assembled for 1946 and earlier Models). 1947 Model switch is assembled same as 1946 and earlier Model switch, except contact plate, Item (9). See paragraph 4 under "Servicing Ignition-Light Switch", Page 110.

Footnote: To maintain interchangeability with earlier switches (not originally fitted with Item 8), Items 7 and 8 are not furnished separately.

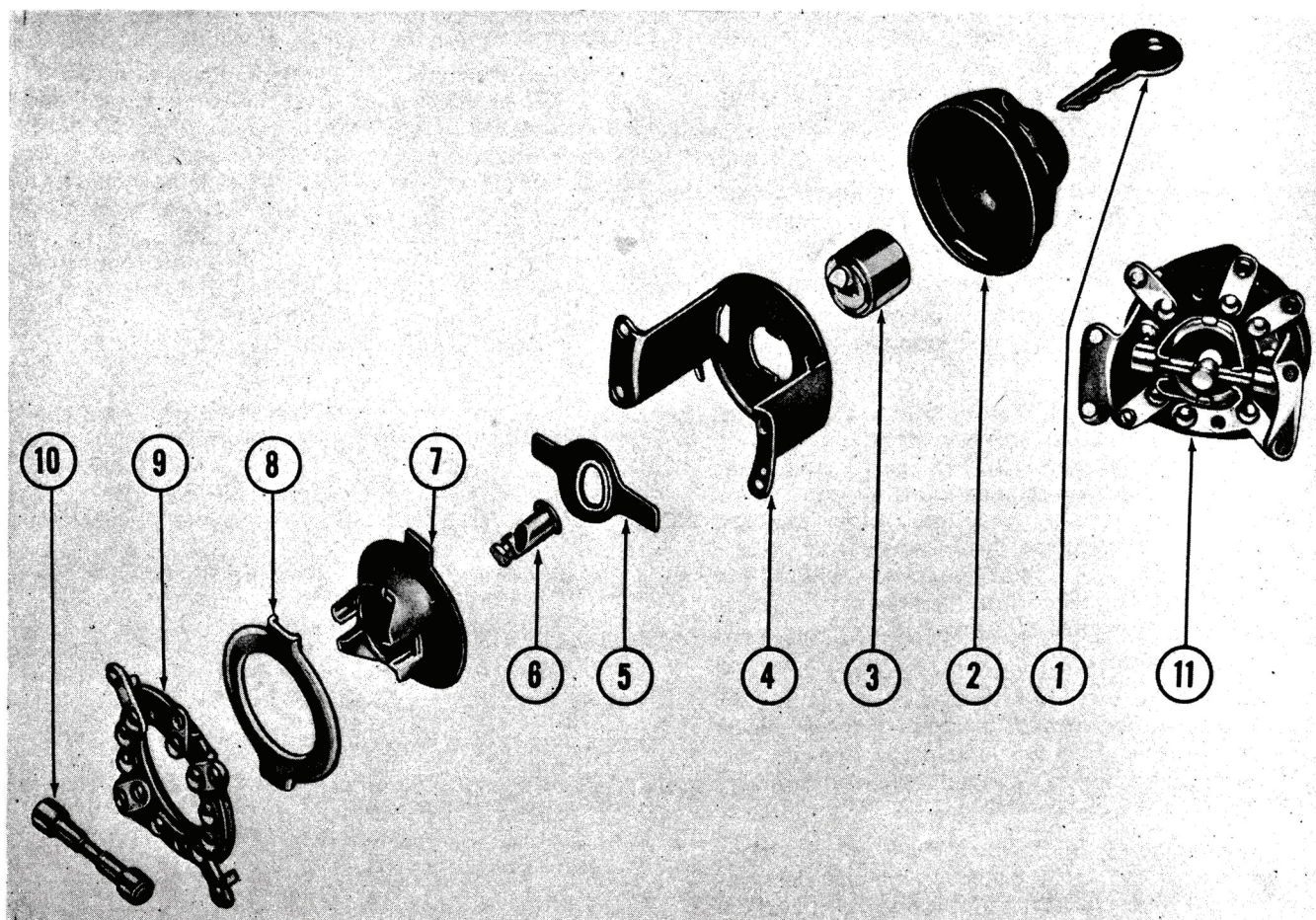

ILLUS. 101
IGNITION-LIGHT SWITCH DISASSEMBLED