

**V-Twin Mfg.
7" Headlamp Chrome Frenched Trim Rim
VT No. 33-0548 and 33-0813**

This is a custom application and rider safety depends on proper installation. This product should only be installed by a knowledgeable and trained motorcycle technician. V-Twin Mfg. accepts no responsibility for improper installation.

This kit fits 1994 and later FLST, FLSTC, FLSTF and FLSTN model motorcycles.

Installation Instructions:

1. Remove the screw from original equipment headlamp trim ring and remove ring.
2. Install new accessory trim ring replacement and tighten screw.

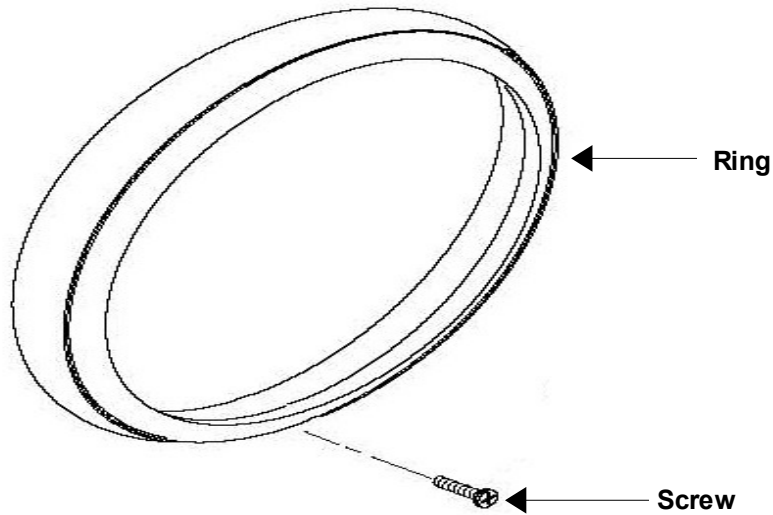

VT No. 33-0813

7 INCH HEADLAMP TRIM RING

This kit fit 1983-2013 Touring motorcycles (except Tour Glide and Road Glide). Kits also fit 1994 and later FLHR models, and 1986 and later FLST models with accessory Chrome Headlight Nacelle (Part Number 67907-96).

INSTALLATION

1. Remove original equipment trim ring screw.

NOTE: If the original equipment trim ring screw is not removed, the accessory trim ring will not fit properly

2. Slip new trim ring over original equipment trim ring. The lip on the back of the accessory ring should slip between headlamp housing and original equipment trim ring.

NOTE: Position mounting screw of accessory trim ring at bottom of headlamp.

3. Tighten original equipment ring screw.