

**V-Twin Mfg.**  
**Cylinder Base Cover Left Side Chrome**  
**Fits 2004-Up XL Models**  
**VT Part No. 42-1171**

This is a custom application and rider safety depends on proper installation. This product should only be installed by a knowledgeable and trained motorcycle technician. V-Twin Mfg. accepts no responsibility for improper installation.

**Installation Instructions:**

1. Remove existing bolt from crankcase.
2. Obtain the cylinder base cover spacer (2) and 5/16-18 socket head cap screw (1) from kit.
3. Insert the screw into the counter bored side of spacer.
4. Loosely install the screw into the engine case. Rotate the spacer so that the 1/4-20 tapped hole is at the 6 o'clock position.
5. Obtain the cylinder base cover (3) from kit.
6. Temporarily position the cover and align the cylinder base cover hole with the spacer hole. If necessary, rotate the spacer slightly to achieve the best cover fit along the primary.
7. Remove the cover and grasp the sides of the spacer with an open end wrench to maintain its position. Tighten screw to 15-19 ft-lbs.
8. Place washer (4) on socket head bolt (5) from kit. Slide bolt and washer through cylinder base cover (3) and install bolt in spacer. Tighten bolt to 80-100 in-lbs.

**Parts list:**

| Item | Description                       |
|------|-----------------------------------|
| 1    | Screw, socket head, 3.5 inch long |
| 2    | Spacer, cover mount               |
| 3    | Cover, cylinder base              |
| 4    | Washer, flat, chrome              |
| 5    | Screw, socket head                |

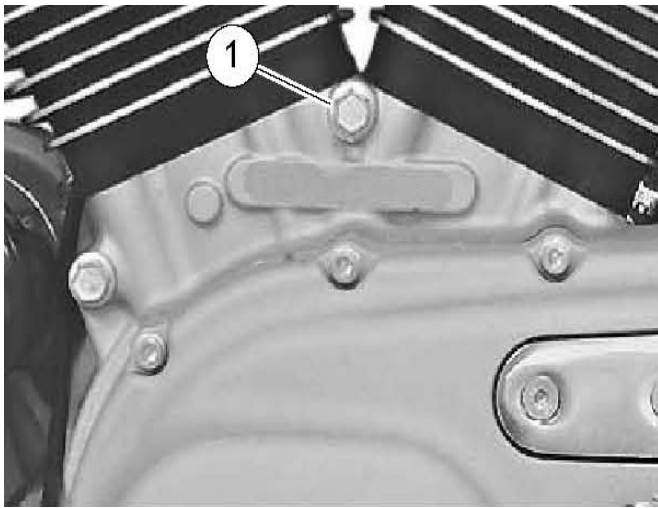

**Remove the crankcase bolt**

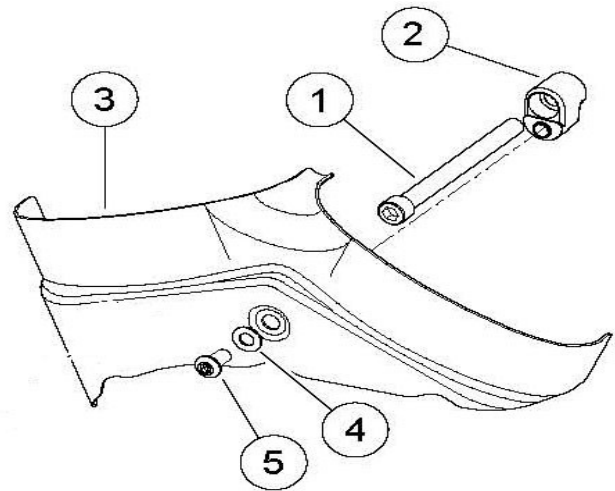

**Base cover parts**