

# INNER FAIRING TRIM KIT

## GENERAL

### Kit Contents

See Figure 2 and Table 1.

## INSTALLATION

### NOTES

- *Ambient temperature should be between 70 °F (21 °C) and 100 °F (38 °C) for proper adhesion. Do not apply below 50 °F (10 °C).*
- *Parts cannot be repositioned after initial adhesive installation.*
- *Allow AT LEAST 24 hours after application before exposing the area to vigorous washing, strong water spray or extreme weather.*
- *The adhesive bond will increase to maximum strength after about 72 hours at normal room temperature.*
- *Do not clean with denatured alcohol, mineral spirits or other solvents. Damage to components may occur.*

1. Using a 50:50 isopropyl alcohol/water solution, thoroughly clean trim mounting surfaces. Allow to dry completely.
2. Install radio bezel (4)
  - a. With the adhesive backing still in place, test fit the radio bezel to mounting location.
  - b. Remove the adhesive backing. Install the radio bezel to the inner fairing.
  - c. Press surface of bezel firmly to make sure that there is good adhesion.
3. Install speedo/tach trim (1)
  - a. With the adhesive backing still in place, test fit the speedo/tach trim to mounting location.
  - b. Remove the adhesive backing. Install the speedo/tach trim to the speedo/tach.
  - c. Press surface of trim firmly to make sure that there is good adhesion.

4. Install gauge bezels (3, 5). Start with left gauge bezel (marked with embossed "L").
  - a. With the adhesive backing still in place, fit the bezel to the gauge opening. Rotate the bezel until it seats in the fairing.
  - b. Place a reference mark on the bezel and on the fairing.
  - c. Remove the adhesive backing from gauge bezel.
  - d. Align the reference marks and install gauge bezel to mounting location.
  - e. Press surface of bezels firmly to make sure that there is good adhesion.
  - f. Repeat for right side bezel.

### NOTE

*Do not damage speaker when inserting right angle tool.*

5. Install speaker trim (2, 6).
  - a. See Figure 1. Carefully insert a right angle tool (3) through a hole in the left grille next to one retainer (1).
  - b. Pull to release retainer.
  - c. Repeat with remaining retainer.
  - d. Remove speaker grille.
  - e. With the adhesive backing still in place, test fit left speaker trim to speaker grille.
  - f. Remove the adhesive backing from speaker trim.
  - g. Install speaker trim to speaker grille.
  - h. Press surface of trim firmly to make sure that there is good adhesion.
  - i. Verify that rubber gasket is in place on perimeter of grille.
  - j. Engage tab (2) into grille opening.
  - k. Engage retainers (1) in slots.
  - l. Push on grille in retainer areas until an audible click is heard.
  - m. Repeat for right side speaker trim.

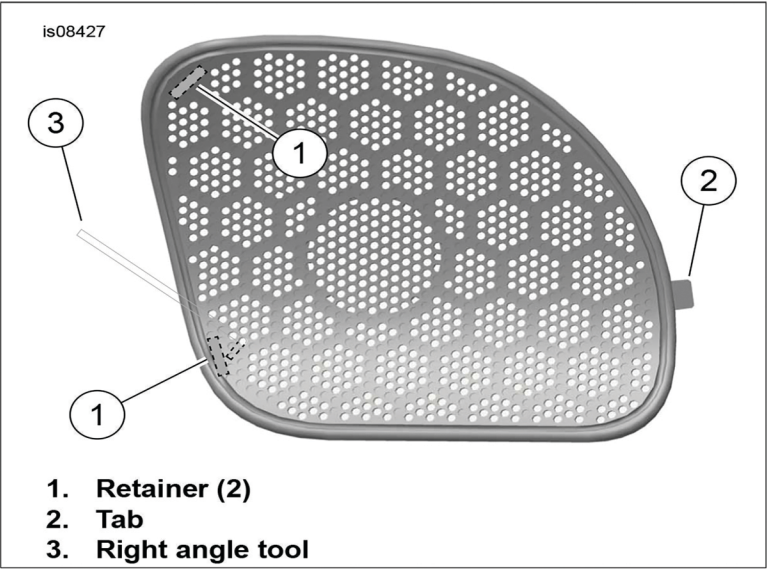

Figure 1. Remove Speaker Grille

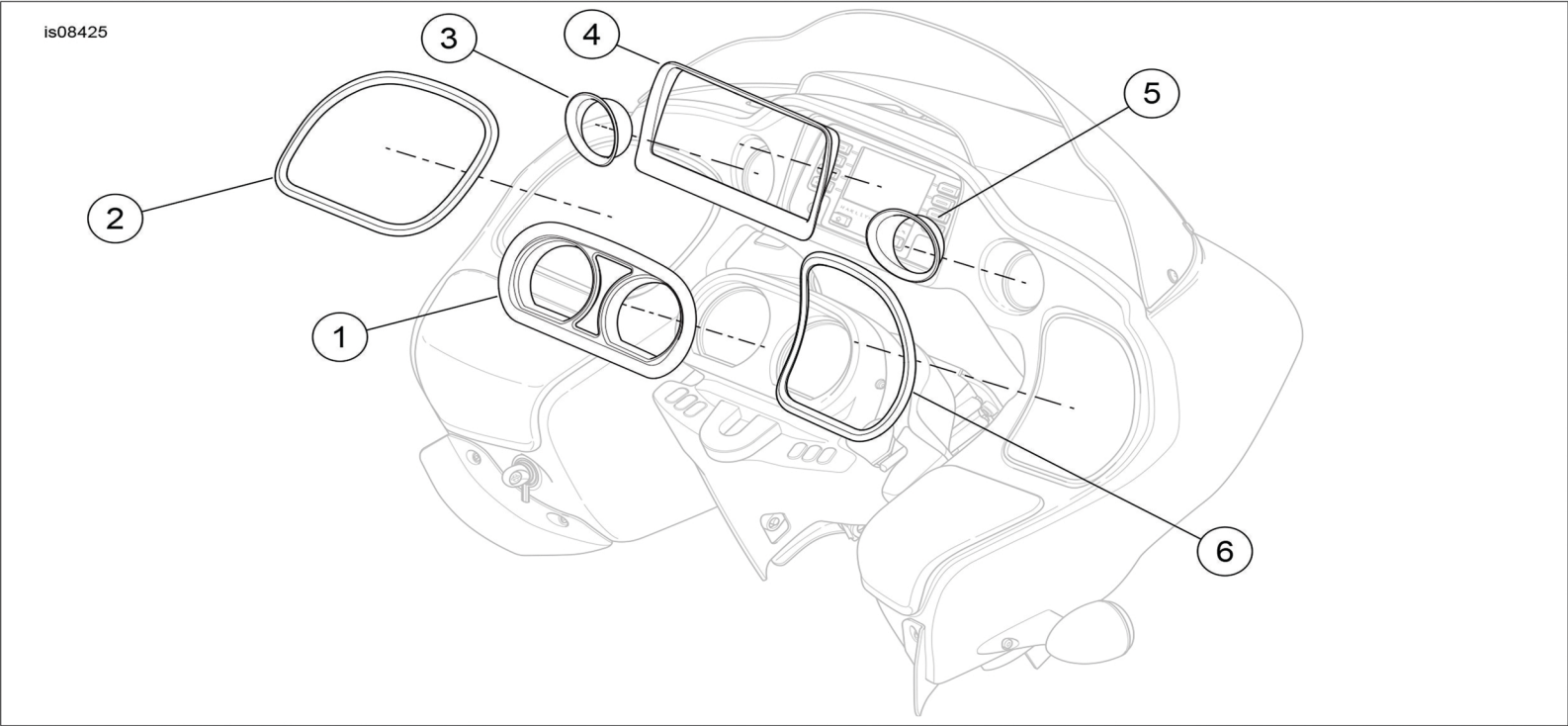

Figure 2. Service Parts

Table 1. Service Parts

Item	Description (Quantity)	Part Number
1	Speedo/Tach Trim	Available within kit 61400299
2	Speaker grill, left	Available within kit 61400297
3	Gauge bezel, left	Available within kit 61400299
4	Radio bezel	61400298
5	Gauge bezel, right	Available within kit 61400299
6	Speaker grill, right	Available within kit 61400297