

SIDEPLATE KIT VT No. 50-0271

Installation Requirements

Loctite® 243 Medium Strength Threadlocker and Sealant - Blue (Part No. 99642-97) is required for proper installation of this kit.

Separate purchase of extra parts or accessories could be required for proper installation of this kit.

WARNING

The rider's safety depends upon the correct installation of this kit. If the procedure is not within your capabilities or you do not have the correct tools, have a dealer perform the installation. Improper installation of this kit could result in death or serious injury.

WARNING

After installing sissy bar/sideplate assembly, pull upward to be sure it is locked in position. While riding, a loose sissy bar/sideplate assembly can shift causing loss of control, which could result in death or serious injury.

INSTALLATION

Sideplate Installation to Docking Points

1. See Figure 1. Stand behind the motorcycle. Place the left side and right side front sideplate notches (2) into the front docking points (4) on the fender supports (3). See Figure 2 for views of correct and incorrect sideplate engagement.

NOTE

Failure to align the front docking points and sideplates could result in damage to the rear docking points.

DO NOT attempt to adjust the sideplates while the motorcycle is in motion.

2. See Figure 3. Position the rotary latches (1) over the rear docking points (4). Pull the rotary latches (1) back to their rearmost position as shown. Check that the sideplate notches (3) and latches fit into the neck (5) of the rear docking points as shown. Gentle squeezing or spreading of the sideplates (2) could be required.

3. Push the rear of the sideplates downward. Close the rotary latches by pressing the latch levers as far forward as they go (see Figure 4). A click is heard when the latches are in place. If the latches do not easily close, do not force.

4. See Figure 5. Insert the legs of the sissybar upright (A) all the way into the channels of the sideplates as shown.

5. Apply a few drops of Loctite 243 - Blue to the clean screw threads (B). Thread the screws into the nuts (C) in the sideplate channels. Tighten to 11–14 N-m (96–120 in-lbs).

6. To remove the sissy bar and sideplate as an assembly, press to release the rotary latches on each side. Pull the latch levers back. Carefully lift the rear of the sideplates up. Pull the sissy bar assembly out of the front docking points.

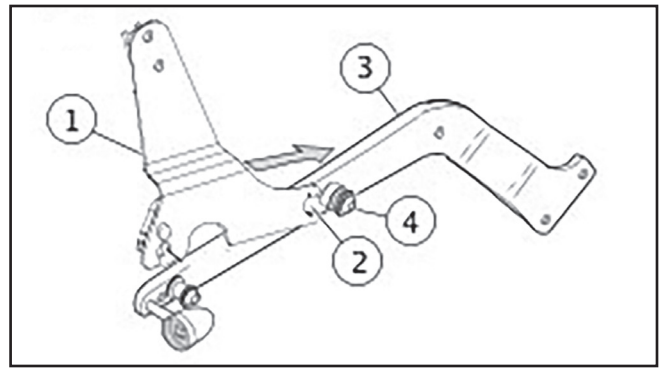

- 1 Sideplate assembly
- 2 Front notch
- 3 Right side fender support
- 4 Front docking points

Figure 1. Place Front Notches into Front Docking Point

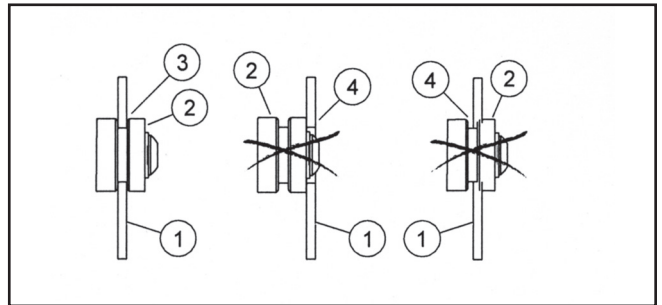

- 1 Sideplate (right side)
- 2 Right front docking point
- 3 Correct: sideplate fully engaged in docking point
- 4 Incorrect: sideplate NOT fully engaged in docking point

Figure 2. Sideplate Fit to Front Docking Points

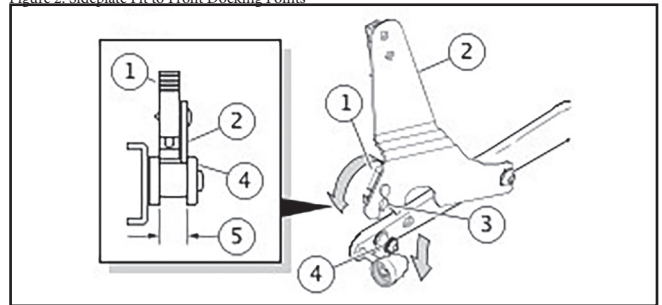

- 1 Rotary latch (2)
- 2 Sideplate (2)
- 3 Sideplate notch (2)
- 4 Rear docking point (2)
- 5 Rear docking point neck (2)

Figure 3. Lower Rear Notches Onto Rear Docking Points

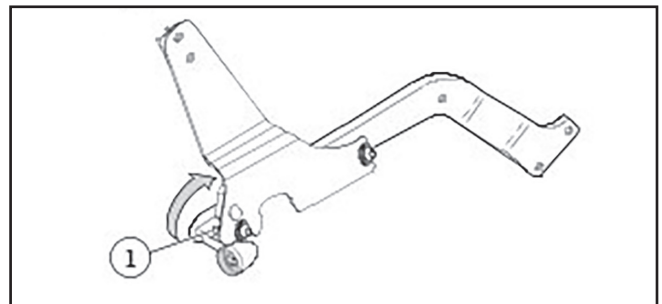

- 1 Release button (2)

Figure 4. Close Rotary Latches

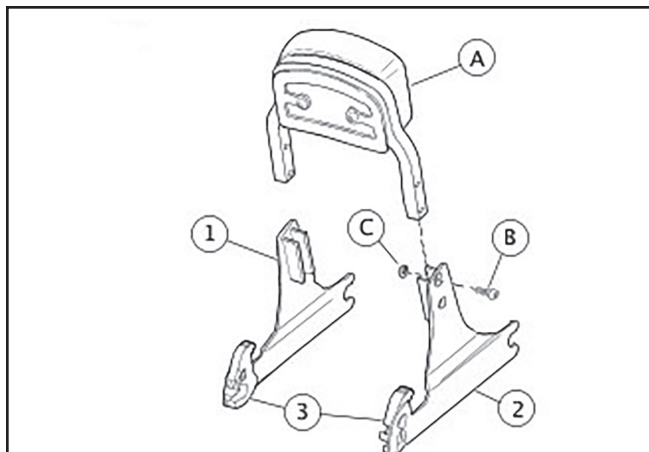

Service Parts

Figure 5. Service Parts: H-D Detachable Sideplates

Table 1.

Parts

Item	Description (Quantity)	Part Number
1	Side plate, left	Not Sold Separately
2	Side plate, right	Not Sold Separately
3	Rotary latch kit (2)	50300108

Items mentioned in text, but not included in kit.

A	Sissy bar upright
B	Screw
C	Nut