

**V-Twin Mfg.
Rear Fender Trim Rail Chrome
Fits 2000-later FLST and FLSTC models.
VT No. 50-2016**

This is a custom application and rider safety depends on proper installation. This product should only be installed by a knowledgeable and trained motorcycle technician. V-Twin Mfg. accepts no responsibility for improper installation.

Installation Instructions:

1. Using a small flat head screw driver, remove rear fender tip light lens cover (A) by gently prying cover away from assembly. There is a notch at top of cover to ease removal. Remove and retain cover (A) and gasket (C).
2. Remove fender tip light assembly (B) by removing two screws, four star washers, and two nuts using a #2 Phillips screw driver and a 3/8 inch wrench. Retain all hardware for reassembly.
3. Remove the hole plugs from the rearmost fender strut holes on both sides of the fender.
4. Mark the fender on both sides of the bike using the rear most fender strut hole as a template.
5. Carefully remove the fender strut and drill a 11/32 inch hole through each side of the fender in locations marked in Step 4.
6. Loosely reinstall the fender strut (D), be sure to allow enough room to slip spacer (1) between the fender (E) and the strut.
7. Align the rear fender rail (2) from kit with rearmost fender strut (D) mounting holes, making sure the lower mounting tab (3) is inside fender (E). Place large chrome washer (4) from kit next to head of button head socket bolts (5) from kit. Insert bolt through fender rail (2), fender strut (D), spacer (1) and fender (E), in that order. Install large unfinished washer (6) from kit onto end of bolt (5). Secure assembly into place by threading locknuts (7) from kit onto ends of bolts (5) from inside of fender (E). Tighten loosely at this time.
8. Install truss head screw (8) from kit through fender (E) and rear fender rail mounting tab (3). Secure into place using small washer (9) and locknut (10) from kit. Use #2 Phillips screwdriver and a 3/8 inch wrench to tighten rear mounting assembly securely.
9. Tighten fender strut bolts (5) to 21-27 ft-lbs.
10. Reinstall the fender tip light assembly (B), gasket (C) and lens (A) using original hardware.

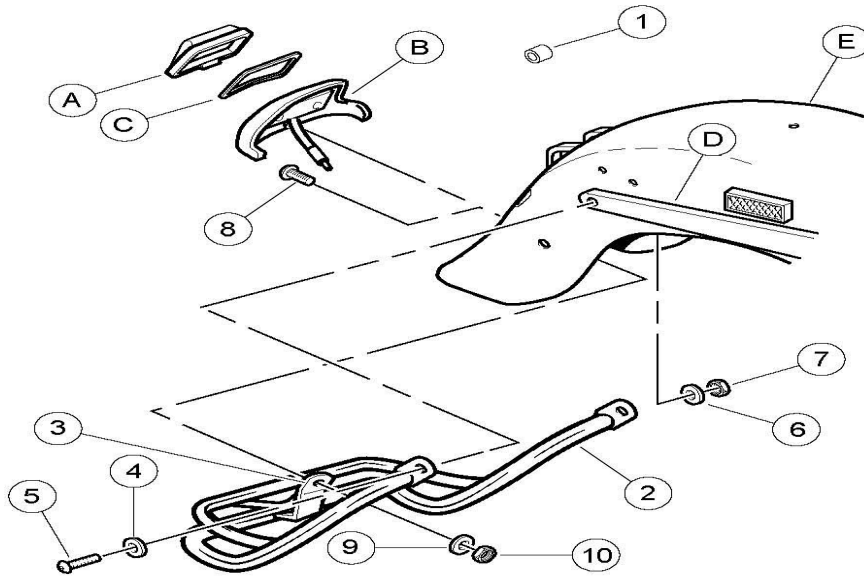

Parts list

Item	Description	Quantity
1	Fender spacer	1
2	Rear fender rail assembly	1
3	Rear fender rail mounting tab	1
4	Washer, chrome, large	2
5	Screw, button head, 5/16-18 x 1-1/2 inch	2
6	Washer, zinc, large	2
7	Nut, hex lock, 5/16-18	2
8	Screw, truss head	1
9	Washer, small	1
10	Locknut, #10-32	1
A	Lens cover, fender tip	Stock
B	Fender light assembly	Stock
C	Gasket	Stock
D	Fender strut	Stock
E	Fender, rear	Stock