

**V-Twin Mfg.
Chrome Front Engine Guard
VT No. 51-0881**

This is a custom application and rider safety depends on proper installation. This product should only be installed by a knowledgeable and trained motorcycle technician. V-Twin Mfg. accepts no responsibility for improper installation.

This kit is designed for installation on 1986-03 XL models equipped with alternators.

Note: Late 1994 and 1995 XL vehicle nut plates have 3/8-16 threads. Reuse original screws on late 1994 and 1995 XL models. Installing the 3/8-24 x 1-1/4 in. screws from kit will damage nut plate and screw threads.

Installation Instructions:

1. From underside of steering head remove screws (7, 8, or 9) and flat washer (6). Discard original screws (7, 8, or 9) and washer (6).
2. Remove and discard the two top motor mount screws, washers, and nuts.
3. Place washer (2) on 5-1/2 in. long screw (1). Insert screw (1) through one motor mount, through spacer (11) (unless engine guard is being installed on a vehicle equipped with forward controls, in which case DO NOT USE SPACER), through the offset end of bracket (3), and (with large offset toward jiffy stand side of vehicle) through the other motor mount. Place kit supplied washer (2) on end of screw (1) and secure with locknut (4). Be sure bracket does not pinch wiring. On 1986 and later models be sure bracket does not contact oil pressure switch.
4. Position engine guard (5) upper mounting bracket under the steering head.
5. Place flat washers (6) on screws (7, 8, or 9):
 A. Use 3/8-24 x 1-1/4 in. screws (8) and 5/16 in. washers (6) from kit on 1986 through early 1994 models.
 B. On late 1994 and later models, reuse the stock 3/8-16 x 1-1/4 in. screws and washers.
 C. Use 3/8-16 x 1-3/4 in. screws (9) and 5/16 in. washers (6) from kit on 1996 and later XL 883 models.
6. Insert screws (7, 8, or 9) through upper bracket on engine guard (5) and thread into nut plate.
7. Attach bracket (3) to engine guard (5) using screw (10) and locknut (4).
8. Tighten nut (4) on screw (10) to 33 ft-lbs.
9. Tighten screw (7, 8, or 9) to 19 ft-lbs.
10. Tighten nut (4) on screw (1) to 33 ft-lbs.
11. On 1986 models, remove clutch cable from clutch hand lever and route cable through engine guard. Reinstall cable at hand lever and adjust freeplay according to procedure outlined in the 1986 XLH Service Manual.
12. Turn handlebars fully to the right and left and check for interference of clutch and brake cables from engine guard.

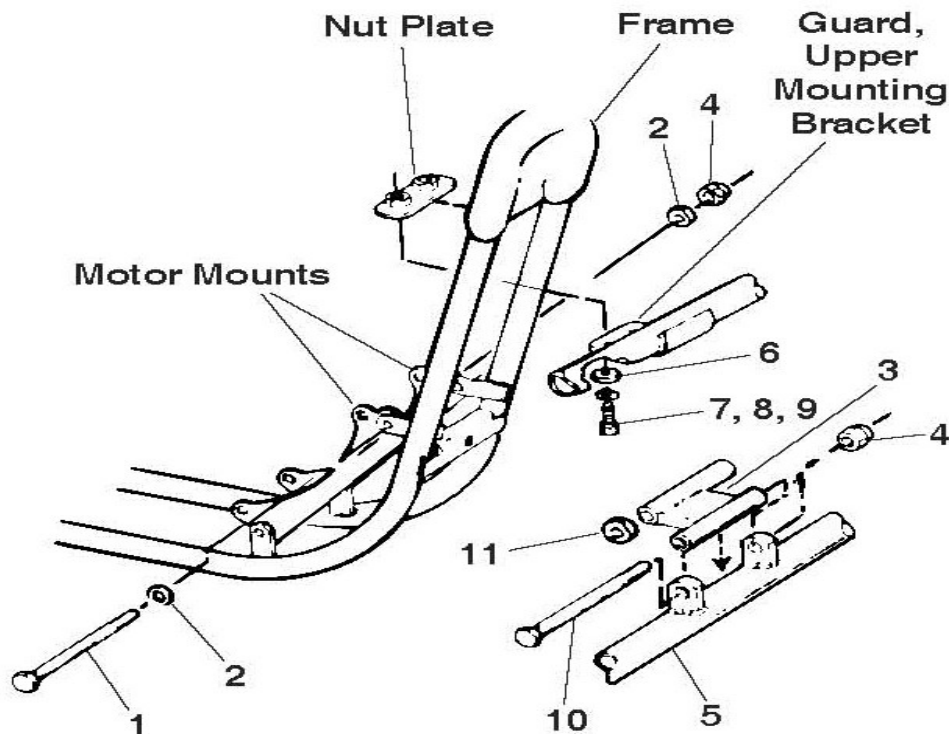

Item Description

1. Screw, 3/8-24 x 5-1/2 in.
2. Washer, 3/8 in. flat
3. Bracket
4. Locknut, 3/8-24
5. Engine Guard
6. Washer, 5/16 in. flat
7. Screw, 5/16-18 x 1-1/2 in
8. Screw, 3/8-24 x 1-1/4 in.
9. Screw, 3/8-16 x 1-3/4 in.
10. Screw, 3/8-24 x 5 in.
11. Spacer, 3/4 x 1/8

Note: Do not use item 11 if equipped with forward controls