

V-Twin Mfg.
Chrome Engine Bar
Fits 1986-1999 FLST Models
VT No. 51-0897

This is a custom application and rider safety depends on proper installation. This product should only be installed by a knowledgeable and trained motorcycle technician. V-Twin Mfg. accepts no responsibility for improper installation.

Installation Instructions:

1. Attach top center mounting flange of engine guard and backing plate to cross brace, located between front downtubes just below the steering head with the 5/16-24 x 1 1/4" bolt, 5/16 flat washer and 5/16-24 nylock nut. Backing plate should be behind cross brace bolt and washer to front of engine guard. Tighten finger tight.
2. To mount left side, remove and discard the front mounting bolt and flat washer (save lockwasher) from the footboard. Position left side mounting tab to inside of footboard mounting plate.
3. Insert 3/8-16 x 1-3/4" long bolt through lockwasher and engine guard mounting flange hole, through footboard mounting plate and thread into footboard mount. Tighten finger tight.
4. Attach engine guard right side to the outside of the forward section of master cylinder mounting plate with 3/8-16 x 1-1/4" bolt and 3/8-16 nylock nut. Tighten to 33 ft-lbs.
5. Tighten engine guard left side mounting hardware to 33 ft-lbs. Tighten engine guard top mounting hardware to 19 ft-lbs.

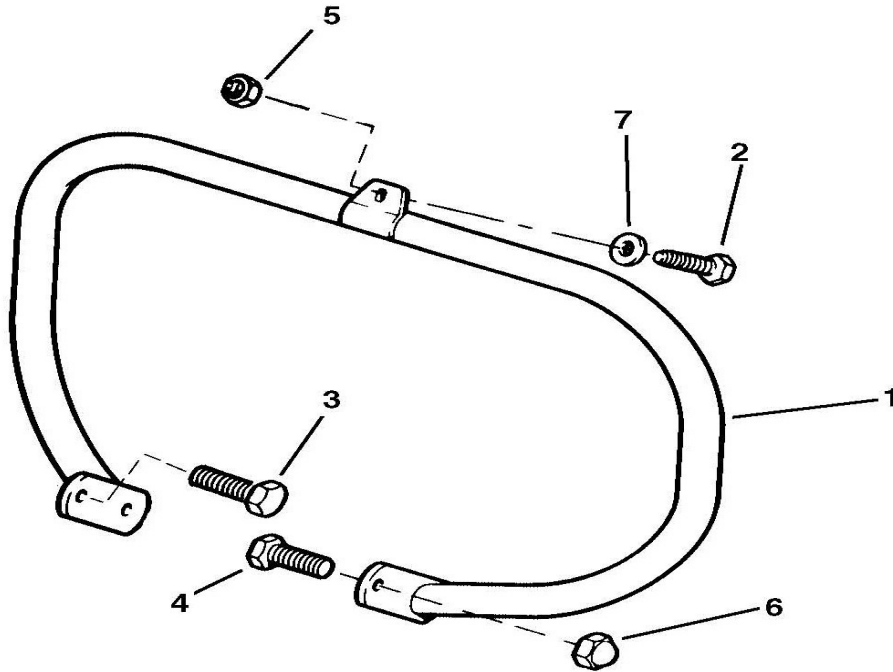

Hardware (not include)

Item	Description
1	Engine Guard
2	Bolt, 5/16-24 x 1-1/4 in.
3	Bolt, 3/8-16 x 1-3/4 in.
4	Bolt, 3/8-16 x 1-1/4 in.
5	Locknut, 5/16-24
6	Nut, 3/8-16
7	Washer, flat, 5/16