



1982-95 Control Kit



1982-95 Chrome Switch Housings and Chrome Switch Assembly includes 48" long leader wires and internal mount screws.
VT No. 32-0560



1982-95 Handlebar Switch Housing Set is a 4 piece chrome set, replace upper and lower of right and left sides including stainless buttonhead screws. Use existing wiring and switches for assembly.

VT No.	Item
26-2149	1982-95 Set, All Models
26-0548	1982-95 Set, All Models
37-8940	25 Screws, OEM 2508 (Buttonhead Stainless)

Chrome Switch Housing Screw Sets for 1982-95.

VT No.	Style
8767-10	Allen
9777-8	Acorn



1982-95 Handlebar Switch Kit includes complete right and left switch assemblies, brake light switch, mounting screws and clips. Individual switches also available.

Black	Chrome	OEM	Item
32-8084	32-9208	Kit	1982-95 Switch Kit
32-8000	32-9070	71599-92	Left turn signal
32-8001	32-9067	71589-92	Engine, Stop-Start
32-8002	—	71591-92	Right turn signal
32-8003	—	71597-92	Dimmer & Horn
32-7782	—	71590-92	Stop switch, front

Hardware for Above, Note: Finish is Not Black

37-8966	—	2907	25 screws pack, zinc
37-8967	—	31557-93	Mount clips, 10 pk, zinc
37-0006	—	5 pk	Spacer, zinc



Handlebar Wiring Harness Kits are color coded.
VT No. Years Type
32-8010 1982-90 Stock
32-8009 1982-90 Extended



Chrome Handlebar Control Kit includes complete chrome master cylinder, clutch handle with clamp and 2 pairs of chrome switch housings. Master cylinder includes a clamp with both a 10mm and a 12mm bolt. All kits include stainless steel

hardware and are attractively display packaged.

VT No.	Years	Item
22-1069	1982-83	Kit, 3/4" Bore
22-1076	1984-95	Kit, 5/8" Bore
22-1099	1982-95	Kit, 11/16" Bore, Dual Disc

When rebuilding 1982-95 front master cylinder check that bleed back passage is clear



Clutch Lever Assembly for 1982-95 models.

VT No.	Item	Finish
26-2125	Assembly	Chrome
26-2188	Assembly	Black
26-2137	Clamp and Bracket	Chrome
26-2165	Clamp and Bracket	Black

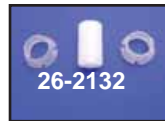
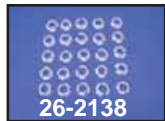
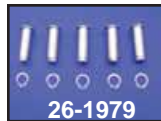
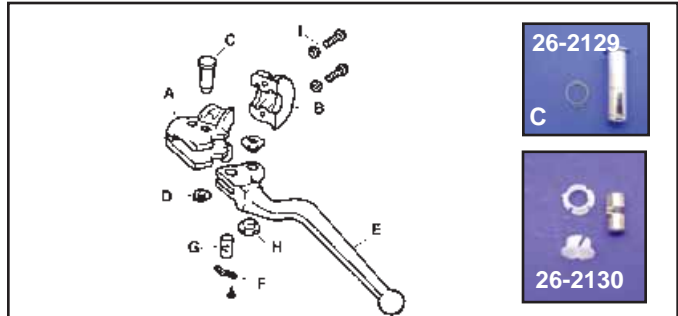

1982-95 Clutch Lever Components

VT No.	#	OEM	Item
26-2137	A	38608-82A	Bracket and
	B	45044-82	Clamp, Chrome
26-2165		As Above	Black
26-2146	B	45044-82	Black Clamp
26-2147	B	45044-82	1982-95 Chrome Clamp
26-2129	C	45032-82	Lever Pin w/ snap ring
26-1979		45032-82	Lever Pins Only 5 pk
12-0944	D	11143	Snap Ring
26-0531	E	45017-82	1982-88 Clutch Lever
26-2133		45017-88	1988-up Clutch Lever
26-2164		45017-93	Clutch Lever
26-2140	F	45021-86	Anti-Rattle Spring
26-2130	G	45036-82	Cable Pin
26-2132		45036-88	Nylon Cable Pin
26-2138	H	45039-68	Pin Bushing
37-8830	I	4015 screw	SS Screw and Washer, 5 of each
26-0400	I	Kit	Chrome Kit, 4 piece