

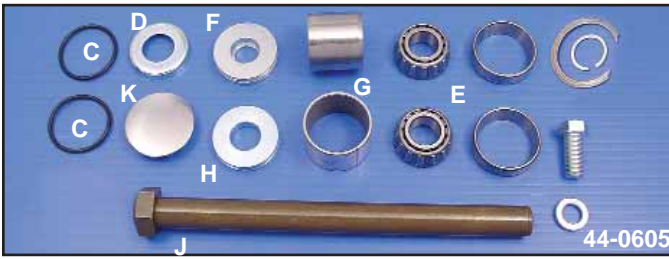

For FXD-FXDWG Swing Arm

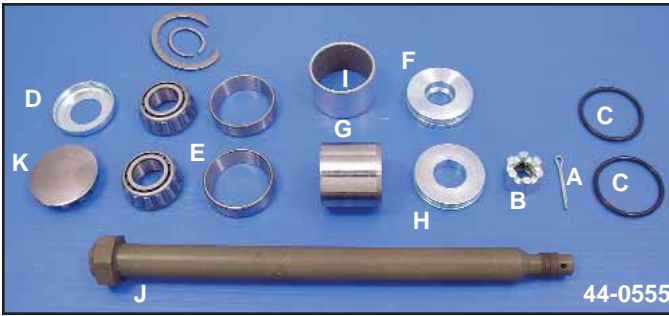

FXD Swing Arm Rebuild Parts. Fit all 1991-up Dyna.

VT No.	#	OEM	Item
44-0555	A-K		1991-99 Complete Kit
44-0605	A-K		2000-05 Complete Kit
44-0790			2006-up Complete Kit
37-8661	A	534	1991-99 Cotter Pin
37-0564	B	7734W	1991-99 Nut
14-0515	C	11139	1991-up O-ring
44-0590	D	41585-90	1991-up Dust Shield
12-0360	E	47082-81	1991-up Bearing Assembly
44-0591	F	47496-90	1991-up Spacer Left Hand
44-0592	G	47499-90	1991-up Spacer Right Hand
44-0593	H	47565-90	1991-99 Washer
44-0594	I	47624-90A	1991-up Bushing
44-0595	J	47817-90	1991-99 Pivot Bolt
44-0606	J	47817-00	2000-up Pivot Bolt
44-0758	J	47641-06	2006-up Pivot Bolt
44-0596	K	67859-90	1991-up Plug, Chrome



Chrome Swing Arms for 2000-up Dyna.

VT No.	Fits
51-0934	2000-05
51-0980	2006-up



RHINEBECK NEW YORK

VINTAGE CYCLE SHOW

HISTORY THAT RUNS!

OVER 500 ANTIQUE & VINTAGE MOTORCYCLES
TIME LINE 1897-1975

FRI. JUNE 11 thru SUN. JUNE 13
 OPEN DAILY 8:00 A.M. • ADMISSION \$15/1DAY \$25/3DAYS KIDS UNDER 13 FREE

3 Big Days of Antique Motorcycles, Parts and Collectibles!
WWW.RHINEBECKNATIONALMEET.COM

LARGEST ANTIQUE MOTORCYCLE SHOW AND SWAP MEET

★ EXHIBITOR • VENDOR • SPACE AVAILABLE ★

4th
ANNUAL

AMCA
2010