



Starter Shaft



17-0085

Starter Shafts and Spacers.

| VT No. | OEM | Fits |
|---------|----------|------------------|
| 17-9944 | 33120-85 | 1986-88 FLT-FXR |
| 17-9939 | 31482-86 | 1986-89 FXST |
| 17-9985 | 31311-80 | Spacer, FLT |
| 17-9984 | 33121-79 | Spacer, FLT |
| 17-0081 | 31493-67 | Nut, FLT |
| 12-0569 | 31312-80 | Nut, FLH Classic |



32-9238

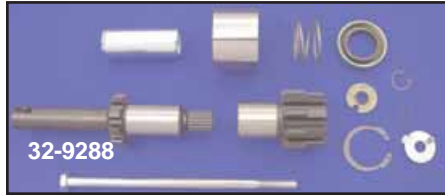

32-9288



32-9200

Starter Shaft Kit includes parts pictured for Big Twins. **Note:** When using VT No. 32-9226 in an 1989 primary chain case, it is necessary to remove the scraper and drive the new seal into the inner primary from the inside to a depth of .110 to .120 inch

| VT No. | Type | Year |
|---------|------|---------|
| 32-9238 | VT | 1989-93 |
| 32-9288 | Kit | 1989-93 |
| 32-9200 | Kit | 1994-up |

Starter Drive



32-0638



32-0639



32-2506



32-9078



32-1561



32-9031



32-9122

Starter Drive for BT features high strength five roller clutch, stainless steel springs, hardened ramped clutch receivers, premium internal bronze bushing and factory pre-lubing.

| VT No. | Item | Fits | Brand |
|---------|-----------|---------|----------------------|
| 32-0638 | 31443-65A | 1965-88 | Accel Heavy Duty |
| 32-0639 | 31443-65A | 1965-88 | Volt Tech |
| 32-2506 | 31443-65A | 1965-88 | Volt Tech Heavy Duty |

32-9078* 31544-90 1989-90 OE

32-1561* 31544-90 1989-90 VT

32-9031* 31663-90 1991-up VT

32-9122* 31663-90 1991-up

*Note: Drive Assemblies



Starter Idler Gears
replace original type.
Fits 1990-up BT.
Replaces 31525-90.
VT No. 32-0679

1991-up Big Twin Starter Return Spring Ball.

VT No. 12-0173



1994-up ST Starter Shaft Kit includes parts shown, drive included.

VT No. 32-9203



Starter Shaft Assembly fits 06-up FXD, and 07-up ST 6-Speed models. Replaces 31633-07.

VT No. 32-0940



Starter Clutch Drive Kits for Big Twins include clutch drive, O-ring, lock tab, seals, spring and cable boot.

| VT No. | Year |
|---------|---------|
| 32-0962 | 1991-92 |
| 32-0963 | 1993 |
| 32-0961 | 1994-up |