



Breather Gear



Stock Plastic Breather Valves.

VT No.	OEM	Year
12-1534	25310-71A	1970-E77
12-1531	25310-82A	L1977-99

C-Thrust Washer Set, Breather Valve for 1950-99 BT includes one of each size noted.



VT No.	Fits	Set
12-1510	1979-82	8 Steel .110, .115, .120, .125 .130, .135, .140, .145
12-1530	1982-99	8 Plastic .130, .135, .140, .145 .150, .155, .160, .165

Thrust Washer Set, Breather Valve for 1950-78 BT. 4 steel, one of each: .110, .115, .120, .125

VT No. 12-1509

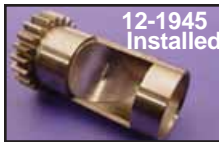

Sifton Air Ramp fits S&S/Sifton Breather Gear on 1936-99 models to remove more air and oil from crankcase. Requires removal of screen for installation. Gear not included.

VT No. 12-1945

Ball Bearings

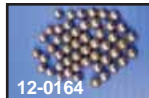
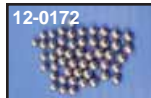

VT No.	OEM	Size	Use/Fits
12-0172	8854	3/16"	1948-52 Hydraulic Unit
12-0161	8856	7/32"	Clutch hub, 1941-54 All
12-0164	8858	1/4"	Oil Filler, 1948-64
12-0158	8866	3/8"	Check valve, 1941-up FL-FLH, Classic, 1971-up all FX, 1954-up all XL
12-0156	8872	1/2"	Shifter Cam Plunger 1941-76 with Handshift
12-0157	8860	5/16"	Clutch Ramp Assy Steering Head 1971-83 All XL's 1954-78 All XL



Sifton™ Breather Gear Kit is constructed of precision ground steel with screen installed. 8 piece steel thrustwasher set included.

VT No.	Year
12-1538	1948-77
12-1543	1978-85

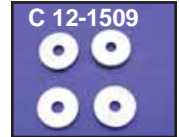

A-Big Twin Steel Breather Valve is a machined breather valve and gear. Designed to replace the stock steel or plastic units. Order 8-piece thrust washers separately. Available in stock duration only with either STD or +.030 O/S outside dimension.

VT No.	Years	Size	Brand
12-0786	1936-47	STD	Sifton
12-9967	1936-47	STD	S&S
12-9968	1936-47	+.030	S&S
12-9907*	1948-77	STD	S&S
12-1536**	1948-77	STD	Sifton
12-9956*	1948-77	+.030	S&S
12-9906	1978-99	STD	S&S
12-1537	1978-99	STD	Sifton
12-9957	1978-99	+.030	S&S
12-9909	All	Washer Set	S&S
12-9978	All	Washer Set	Sifton
12-9909	All	Washer Set	S&S
12-1510	All	Washer Set	Sifton

*Note: Must be used with 1954-77 Pinion & Cam Gears.

**Note: Must be used with late 1979-82 type thrustwashers only.



Sifton Oil Pump Drive Gear provides updated higher scavenging for 1939-53 OHV.
VT No. 12-1496

Breather Parts



Big Twin Pinion Parts. Kit is complete with proper parts.

VT No.	Fits	Kit
12-0101	1936-53	5 pc. Kit
12-0102	1955-69	4 pc. Kit

Pinion Shaft Seal Ring is used on all 1940-53 OHV Big Twins, sold each. Replaces 24697-40.

VT No. 12-1525



Breather Screens and Separator fits 1936-69 BT, 5 pk.

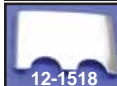

VT No.	OEM	Item
12-1517	25275-36	Screen
12-1518	25279-36	Separator

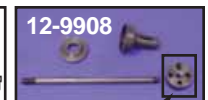
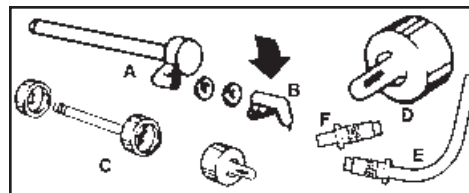

Cap and Collar have been pressed together

Primary Breather Tubes for Big Twin models.

VT No.	#	OEM	Years	Item
12-1514	A	24912-48	1948-57	Tube
12-1448	A	29411-36	1936-47	Tube
12-1528	B	24918-64	1936-57	Snoot
12-9908*	C	Kit	1958-64	All
12-1513	D	24918-58	1958-64	Rubber Nipple
40-0547	E	24912-65	1965-66	Tube with Nut
40-0548	F	24913-67	1967	Tube with Nut
12-1191		24914-58	1958-64	Stud Only

*Note: Includes 24925-58 spacer, 24914-58 stud, (24922-58 collar, 24923-58 cap Note: cap and collar have been pressed together) and 24918-58 rubber nipple.