



Brake Cable Component



Front Brake Cable Components.

VT No.	Model/Item	Finish
24-0142	1949-71 FLH Adjuster & Tube Kit	Chrome
24-0644	1949-71 FLH Adjuster & Tube Kit	Cadmium Tube
8818-3	FL-XL Adjuster only	Zinc Adj.
9741-2	FL-XL Adjuster only	Chrome
24-0143	1960-67 FLH Crossover Tube Left Side Brake	Chrome
24-0645	1960-67 FLH Crossover Tube Left Side Brake	Cadmium
36-2385	1948-71 FL, 1952-72 K-XL, 60" Brake Cable cut to length	
24-0095	1952-72 K-XL Cable Tube only	Chrome
24-0646	1952-72 K-XL Cable Tube only	Cadmium
31-5008	1952-72 K-XL Tube Clamp	Chrome

Glide Cable and Fitting Kit features parts pictured to install brake cable on 1949-71 glide forks, handle, cable, adjuster, tube and fitting included.

VT No.	Item	Finish	Years
24-0141	Complete Kit (Polished Lever)	Chrome	1965-71
36-0415	Complete Chrome		1949-64
36-0416	Complete Cadmium		1949-64
24-0142	Tube and Adjuster Only	Chrome	1949-64
8818-3	Adjuster Only	Cadmium	1949-71
9741-2	Adjuster Only	Chrome	1949-71
36-0419	Adjuster Only	Chrome	1949-71
36-0420	Adjuster Only	Zinc	1949-71
36-2385	Cable Only		1949-71



1965-72 Glide Cable/Handle Assemblies.

VT No.	Finish
36-0576	Polish
36-0577	Chrome



Cross Over Brake Tube Kits allow the use of left side brake drum with 1949-68 footshift models with a right hand brake handle assembly. Kits include handle, cable, adjuster and cross over tube.

VT No.	Finish	Years
24-0204	Polish/Cadmium	1949-64
24-0205	Chrome	1949-64
24-0208	Polished Cadmium	1965-68
24-0209	Chrome	1965-68

Damper Knob Kit

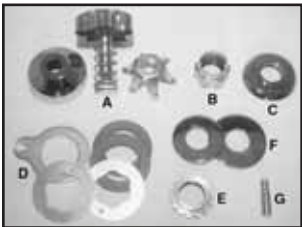

FLH Glide Steering Damper Hardware for 1949-59 FL with drilled and tapped fork stem.

VT No.	#	OEM	Item
24-0753		Kit	A-B-D-G
24-0254	A	47640-48 46751-48 46710-48 46715-48	Chrome Adjusting Knob Kit with spring and spider washer
24-0207		46740-48 46710-48	Damper Knob with Cover
24-0120	B	45718-48	Crenelated stem nut (Cadmium)
24-0113	C	48330-48	Chrome Seat Nut w/Dust Guard
24-0115	D	46718-48 46720-48 46730-48 46727-48	Friction Disc Set, 5 piece Set
15-0697		46727-48	(2) Friction Washer only
24-0175		46727-48	Plate with Hole, each
24-0174		46720-48	Plate with Pin, each
24-0176		46730-48	Plate with Tab, each
24-0278	E	48330-48B	Cone Cover Nut
24-0117	F	48365-48A 48361-80	Dust Shield Set Upper and Lower
37-9097	G	46731-48	Frame Anchor Pin, ea

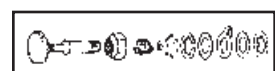

24-0202

1960-84 FL Steering Damper Assembly Unit

includes all pieces shown, including alloy adjusting knob. Order 24-9963

chrome handlebar clamp cover to complete installation.

VT No.	OEM	Item
24-0202	46700-60	Kit Complete
24-0201	46746-52	Knob Only
24-1060	Polished	Riser Cover



Steering Damper is machined alloy and universal, multi-position, and adjustable, can be secured between the frame and most forks. Fork tube and frame clamps sold separately.

VT No. 24-0168