

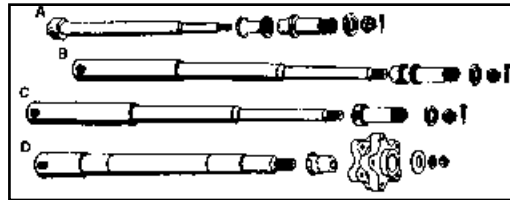

Front Axle Kits



Front Axle Kits include plated axle, nuts, spacer and hardware. Axle sleeve included when required.

Year/Model	Kit	Spacer	Nut Kit	Axle	Axle OEM	Finish #
1936-48 BT Spring Fork with Sleeve 44-0300	44-0581 44-1983	44-0304 44-0111	8162-3 9406-3	44-0209 44-0085	43872-36 (Black)	Chrome A Black
1948-66 FL Glide, with Sleeve 44-0301	44-0568 44-0225	—	8162-3 8163-3	44-0200 44-0224	43875-48 43875-48	Chrome B Zinc
1967-71 FL Glide, with Sleeve 44-0302	44-0569	—	8162-3	44-0201	43875-67	Chrome C
1972 only FL Glide with spacer and flange	44-0240	44-0397	8769-3	44-0228	43875-72	Chrome D
1973-80 FL Glide, 1980-83 FXWG	44-0570	44-0303	8769-3	44-0202	43875-73	41
1981-85 FLH	44-0571	44-0303	8769-3	44-0203	43867-81	41
1970-72 FX (Zinc)	44-0573	—	44-0308	44-0204	43871-52	33
1973-77 FX	44-0574	—	8768-3	44-0205	43871-73	35
1977-83 FXE	44-0576	—	8768-3	44-0206	43883-77	35

Axles have chrome plated ends, except as noted. Order nut kit separately.

VT No.	OEM	Fits	Finish
44-0209	43872-36	1932-47 Springer Type Fork	Chrome
44-0085	43872-36	As above	Black
49-1963	43871-30	1930-52 45" Solo	Black
49-0260	—	1941-44 WLC	Black
44-0200	43875-48	1948-66 FL	Chrome
44-0224	43875-48	As Above	Zinc
44-0228	43875-72	1972 only	Chrome
44-0201	43875-67	1967-71 FL	Chrome
44-0202	43875-73	1973-80 FL, 1980-83 FXWG	Chrome
44-0222	43875-73	As above	Zinc
44-0203	43867-81	1981-85 FLH	Chrome
44-0208	43346-83	1983-86 FXWG, 1981-85 FLH-80, 1984-99 all FLT, 1984-up FXST	Chrome
44-0204	43871-52	1952-72 XL 1970-72 FX	Zinc
44-0205	43871-73	1973-77 XL-FX	Chrome
44-0206	43883-77	1978-83 XL's 1977-83 All FX except FXWG	Chrome



Big Twin Front Axle Cap Cover Sets include right and left caps with set screws for glide type forks. Cap included for anchor stud on 37-0035 only.

VT No.	Type	Year/Model
37-0035	3 pc	1949-71 FLH
37-1510	1 pc	1949-71 Stud
37-0034	2 pc	1949-71 FLH
37-0038	Ball	1972-up FXWG-FLT-FXST-FLH
37-0036	Cap	1972-84 FXWG-FLT-FXST FLH and XL-FX with 39mm

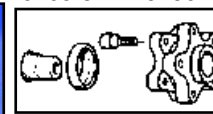
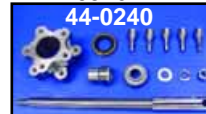

Left Side Disc Hub Flange is used when large type disc caliper is mounted to glide FL fork on 1972 only.

VT No.	Type
44-0240	Complete Hub Flange Kit with axle
45-0314	1967-72, Flange only
44-0397	Spacer Left
44-0228	Chrome Axle Only
12-0331	1967-72, Flange Bearing only
23-0440	Chrome Lug Bolt Set

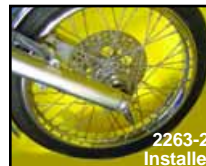

Pike Front Axle Nut Kit fits 1972-up WG, 1984-up ST models and 39mm FXR and FXD.

VT No. 2263-2



Chrome Axle Nut Caps Set for both axle nut and axle head where required, set screws and hex key wrench. Each cap has an internal hex to allow more thickness for the set screws thread to eliminate thread stripping.

Note: These axle caps will not work on late model rear axles with cotter key locking devices.



Front	Rear	Fitment
37-0039	37-8885	1982-86 FXWG
37-0039	37-8884	1980-81 FXWG
—	37-8885	1981-85 FX, Except FXWG-FXST
—	37-8884	1973-80 FX, Except FXWG
	37-8886	1971-72 FX
37-0039	37-8885	1980-94 FLT
		Does Not Fit Rear 1989-94
37-0039	37-8885	1981-84 FLH
37-0039	37-8884	1973-80 FLH
37-0039	37-8886	1972 FLH
37-0039	37-8885	1981-84 FLH
37-0039	37-8884	1973-80 FLH

Note: 37-8880 each, remainder in pairs