



Rear Axle Adjuster Sets.

VT No.	OEM	Models
44-0334	41570-77 47554-73	1979-96 w/chrome end caps
44-0335	41570-77	As Above (Zinc)
44-0602	41573-97 47554-73A	1997-2004
44-0434	41573-05	2005-up



Rear Chain Adjusters available in pairs with nuts. Fits 1952-78.

VT No.	Finish
7703-2	Chrome
9020-2	Cadmium



Axle Protector Plates prevent axle nuts from scratching painted finish. Sold in pairs, polished stainless. Fits 1979-2004.

VT No. 44-1990

Wheel Adjusters



Chrome Pyramid Axle Adjusters includes nuts.

VT No.	Years	Item
44-0251	1997-03	Blocks Only
44-0365	1979-96	Complete Kit
44-0366	1979-96	Blocks Only



Chrome Calibrated Rear Wheel Adjusters feature chrome pyramid blocks with sight indicator to view calibrated adjuster bolt, for accurate and easy wheel alignment. Adjuster bolt is 1/2" rod with micrometer markings, nut is stainless steel. Fits 1979-96.

VT No. 44-2011

Hub Rebuilds



1955-78 XLH-XLCH

XLCH-XLH Rear Hub Rebuild Kit for use on all model steel hubs 1955-78, complete with all parts illustrated, everything necessary to install in a bare hub!

VT No. 44-0404



Hub Lock Nut Kit includes correct locknut spacer and seal for rear. Fits 1955-78.

VT No. 44-0412

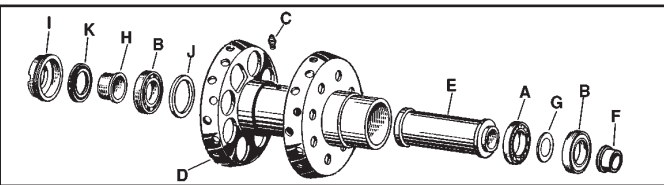

Rear Hub Hardware fits 1952-78.

VT No.	OEM	#	Item
44-0404	Kit	All	Complete Hub Rebuild
12-0305	9008	A	Bearing without shield
12-0374	9009	B	Bearing with shield
44-0533	9851	C	Grease Fitting, 10 pack
45-0301	41017-55C	D	Complete Chrome Hub
44-0315	41185-63	E	Hub Spacer, each
44-1999	41195-52	F	Brake side Washer 1954-62
44-0395	41195-63	G	Brake side Washer 54-62, 10 pk
44-0392	41196-55	H	Seal Spacer, each
44-0529	41201-55	I	Locknut, R.H.
44-0396	41205-52	J	Bearing Washer, 10 pack
14-0131	41210-55	K	Seal, 5 pack



Front Internal Hub Kit includes all internal parts for complete rebuilding of all alloy front hubs. Includes inner spacer, bearings, races seals and seal spacer matched for each year group. Hub is not included.

VT No.	Type	Fits
44-0403	Drum	1964-72 XL-XLH
12-0906	Drum	Snap Ring for Above
44-0402	10" Disc	1973-only XL
44-0401	11" Disc	1974-77 XL
44-0400	Dual Disc	1977-83 XL
44-0537	11" Disc	1984-91 XL
44-0611	11" Disc	2000-up XL



Rear Double Row Retro fit wheel bearing kits for models with Timken bearings. Double row wheel bearings eliminate wheel play, have a longer wear life, require no adjustment. Kit includes two bearings, center spacer & spacers. Fits 1991-99 XL.

VT No. 44-2995

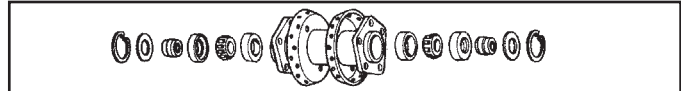

Rear Hub Rebuild Kits include all parts pictured less hub and internal bearing spacer. Fits 1979-up.

VT No.	Fits	Wheel Type
44-0460	1979-81	Cast or Wire
44-0461	1982-83	Cast only
44-0462	1982-85	Wire only
44-0453	1986-99	Cast or Wire