

**V-Twin Mfg.
Clutch spring compressor tool
VT No. 16-1514**

For use on 1990-1997 BT Models & 1991-Present XL Models

This tool should only be used by a knowledgeable and trained motorcycle technician. V-Twin Mfg. Expects no responsibility for improper use. This tool includes pieces so it can be used on Big Twin and XL applications.

Instructions for BIG TWIN 1990-1997 (Note: 5, 6, 7 not used)

1. Refer to appropriate service manual for removal the primary cover.
2. Loosen the jam nut and remove the adjusting screw.
3. Place the tool (#1) over the clutch diaphragm.
4. Slip forcing bolt through hole in top of tool with nut almost to the hex end of the bolt, with washer in front of nut.

Note: Apply oil to all threads and pushing surfaces.

5. Thread forcing screw into the hole in release plate at least 5 complete turns.
6. While keeping bolt from turning, turn nut with washer up against tool . Compress the diaphragm spring inward just enough to remove retaining ring.
7. Remove retaining ring.
8. Slowly remove tool with pressure plate attached.

Caution: Do not loosen spring compressing tool if you are not replacing the pressure plate.

9. The clutch can now be disassembled.

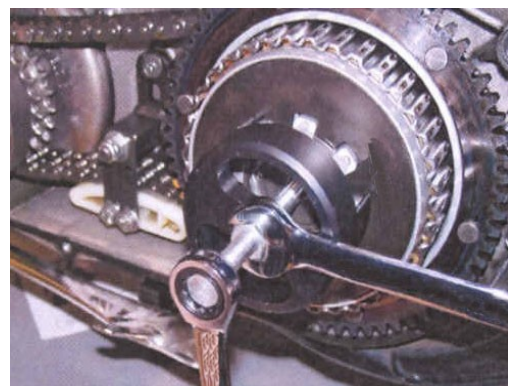
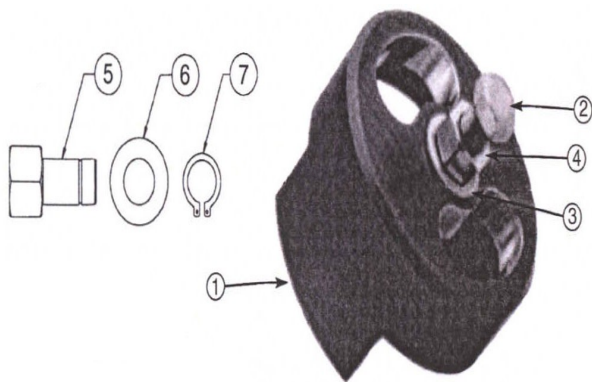

Instructions for 1991-Present XL Models (includes Buell Blast) (Note: 4, 3, 2 not used)

1. Remove the primary cover as stated in the service manual.
2. Loosen and remove the jam nut.
3. Place the tool (#1) over the clutch assembly.
4. Thread the assembled adapter (5, 6 & 7) onto the adjusting screw.

Note: Apply anti seize to all the threads and pushing surface.

5. Using a thin screwdriver, hold the adjusting screw from turning. Compress the diaphragm spring just enough to remove the snap ring retainer.
6. Remove the pressure plate slowly with the tool attached.

CAUTION: Be sure not to loosen the spring compressor tool if you are not replacing the pressure plate.

7. The clutch can now be disassembled.

