

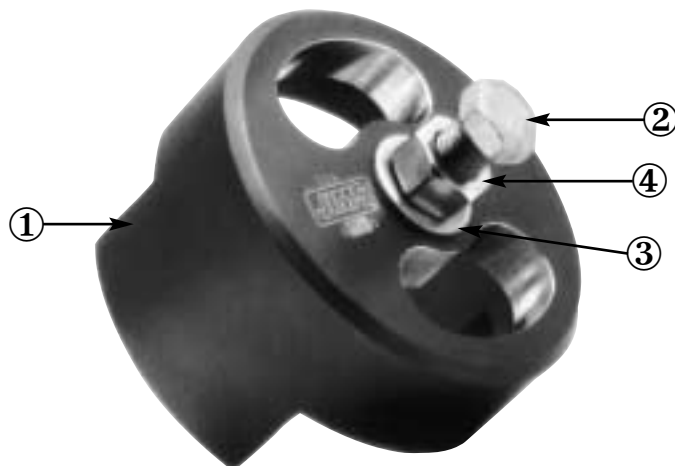

# Instruction Sheet For Tool No.38515-90

Clutch Spring Compressor  
Use on Big Twin 1990-Present



1. Refer to H.D.® Service Manual for removal of primary cover.
2. Loosen jam nut and remove adjuster screw and adjuster nut.
3. Hold cup portion of tool #38515-90-1, up against clutch diaphragm.
4. Slip forcing bolt #2036 through hole in top of tool with nut #2033 almost to the hex end of bolt, with washer #2037 in front of nut. Note: Apply oil to all threads and pushing surfaces.
5. Thread forcing screw into the hole in release plate at least 5 complete turns.
6. While keeping bolt from turning, turn nut with washer up against tool. Compress the diaphragm spring inward just enough to remove retaining ring.
7. Remove retaining ring.
8. Slowly remove tool with pressure plate attached. Caution: Do not loosen spring compressing tool if you are not replacing the pressure plate.
9. Clutch can now be disassembled.

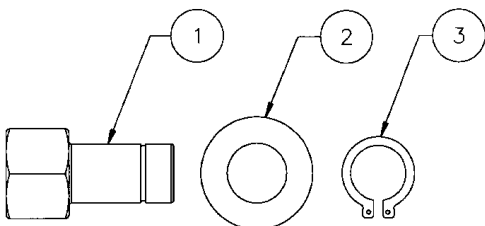

## PARTS AVAILABLE SEPARATELY

No.	Qty.	Description	Part No.
1	1	CUP	38515-90-1
2	1	BOLT	2036
3	1	WASHER	2037
4	1	HEX NUT	2033

**CAUTION:** Wear safety glasses. Excessive force may damage parts or tools. Warning disconnect negative cable of battery to avoid accidental start ups.

**"FROM THE TRACK... TO THE STREET!"**