

VT No. 21-1666 and 21-1668 Heel Shifter

General Information

Item	Qty	Description
1	1	Shift lever, chrome, Kit, VT No. 21-1666
1	1	Shift lever, black, Kit, VT No.21-1668
2	1	Spacer, shifter shaft
3	1	Nut
4	1	Rubber peg, shifter
5	1	Peg, stud, 12–16 N·m (9–12 ft-lbs)
6	1	Screw, SEMS. 12–16 N·m (9–12 ft-lbs)

Items mentioned in text, but not included in kit

A	1	Shift lever
B	1	OE Rubber peg, shifter
C	1	Peg, stud
D	1	Nut
E	1	Screw, SEMS
F	1	Shaft, shifter
G	1	Spacer, shifter shaft

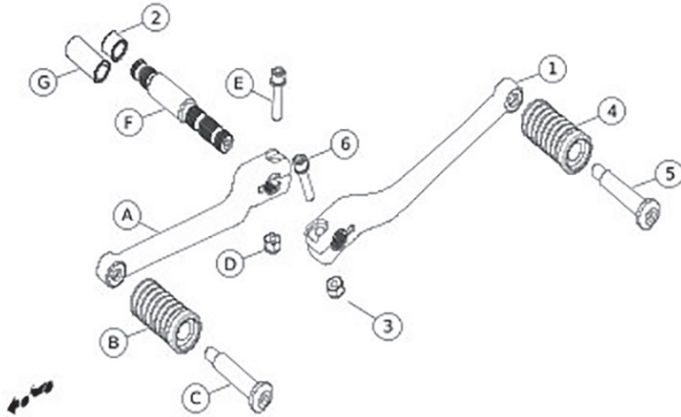

GENERAL

Models

For model fitment information, see the V-Twin or our website www.vtwinmfg.com.

Verify that the most current version of the instruction sheet is used.

Installation Requirements

WARNING

Rider and passenger safety depend upon the correct installation of this kit. If the procedure is not within your capabilities or you do not have the correct tools, have a dealer perform the installation. Improper installation of this kit could result in death or serious injury.

PREPARE

1. Mark position of toe shifter with a grease pencil before removal.

REMOVE

1. Remove toe shifter (A).
2. Retain hardware.
3. Remove long spacer (G).

INSTALL

1. Install short spacer (2) from kit.
2. Install toe shifter, inboard (A).
 - a. Align screw (E) to groove.
 - b. Secure screw (E) and nut (D). Tighten.
Torque: 12–16 N·m (9–12 ft-lbs)
3. Install heel shifter, outboard (1).
 - a. Align screw (6) to groove.
 - b. Secure screw (6) and nut (3). Tighten.
Torque: 12–16 N·m (9–12 ft-lbs)
4. Install peg stud (5) through rubber peg (4). Tighten.
Torque: 12–16 N·m (9–12 ft-lbs)
5. Ensure there is full travel to perform upshifts and downshifts.
6. Levers should be approximately 160° apart.