

## VT No. 26-0536 Handlebar Reservoir Cover Set

### Models

Kit fits the following models with single-disc front brake.

1996-23 XL (Sportster®) models

1996-17 Dyna models

1996-14 Softail® models

### NOTE

These kits DO NOT fit VRSC (V-rod®) models, or models equipped with a hydraulic clutch.

### Kit Contents

### INSTALLATION

1. Adjust the clutch cable for maximum free play. With snap ring pliers, remove and retain the external snap ring from the bottom of the clutch lever pivot pin. Remove the pivot pin, clutch lever, clutch cable and rear-view mirror from the clutch bracket.

2. See Figure 1. Install the new chrome clutch bracket (1) using a clamp half (2), washers (3) and screws (4) from the kit. Tighten the screws to 70-80 in-lbs (7.9-9.0 Nm).

3. Re-install the clutch cable and clutch lever, mirror and pivot pin and snap ring. See Figure 2. Re-adjust the clutch cable so there is a 1/16-1/8 inch (1.6-3.1 mm) gap between the clutch cable ferrule and the end of the clutch bracket (1).

4. Remove the original clamp half from the front brake master cylinder assembly.

5. See Figure 1. Install the new chrome clamp half (2) on the front brake master cylinder assembly using washers (3) and screws (4) from the kit. Tighten the screws to 70-80 in-lbs (7.9-9.0 Nm).

6. Remove the two screws retaining the brake master cylinder reservoir cover. See Figure 3. Replace with the two standoff studs (1) in the kit. Tighten to 6-8 in-lbs (0.7-0.9 Nm).

7. Remove the rear-view mirror from the front brake master cylinder assembly. Place the new chrome brake reservoir cover from the kit in position. The holes in the top of the cover should line up with the holes in the standoff studs. Fasten the cover to the studs with the wave washers (7) and screws (8) from the kit.

8. Reinstall the rear-view mirror.

### WARNING

Be sure that steering is smooth and free without interference. Interference with steering could result in loss of vehicle control and death or serious injury.

Be sure clutch cable and brake line do not pull tight when handlebars are turned fully to left or right fork stops.

9. Check both the brake and clutch controls for free, unrestricted movement and travel.

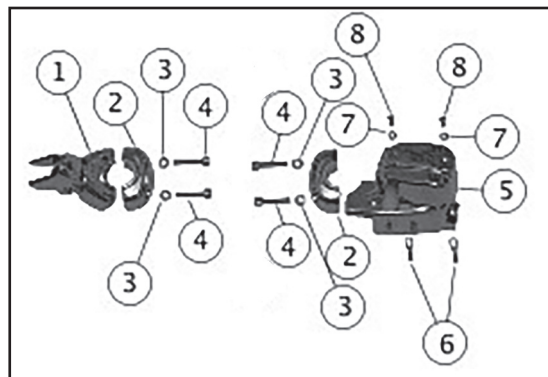

Figure 1. Kit Components

Table 1. Figure 1. Kit Contents

#	DESCRIPTION (QUANTITY)
1	Chrome clutch bracket
2	Handlebar clamp half (2)
3	Flat washer (4)
4	Screw, 1-1/4 inch long (4)
5	Chrome brake reservoir cover
6	Standoff stud (2)
7	Wave washer (2)
8	Screw, 3/16 inch long (2)

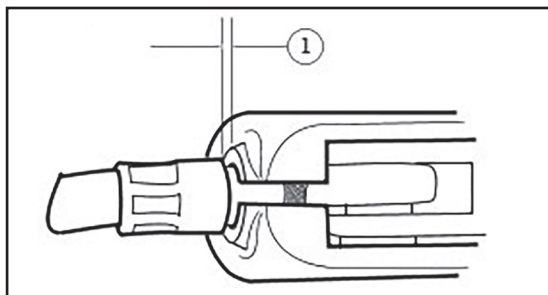

Figure 2. Clutch Cable Adjustment

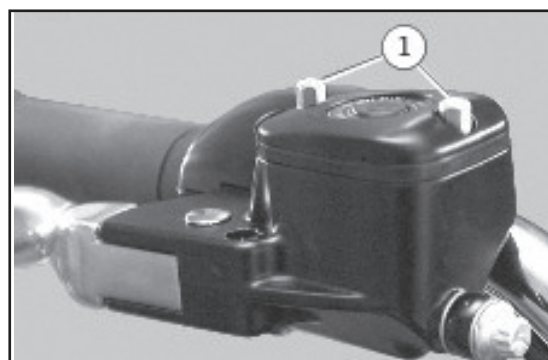

Figure 3. Installing Standoff Studs

