

PARTS INCLUDED

- 1 Left Rear Bracket
- 1 Right Rear Bracket
- 1 Left Front Bracket
- 1 Right Front Bracket
- 1 Hardware Kit Including:
 - 4 1/4"-20 Nylon Locking Nuts
 - 4 1/4"-20 x 1-1/4" Shoulder Bolts
 - 8 1/4"-20 Flat Washers
 - 2 #10-32 x 3/8" Stainless Set Screws
 - 1 Installation Instructions

Please read and understand entire instructions before starting installation.

TOOLS SUGGESTED

Set of Hex Wrenches, Combination Wrenches or Socket Set and Ratchet

IN ORDER TO PROTECT YOU AND OTHERS FROM POSSIBLE INJURY AND/OR PROPERTY DAMAGE OR LOSS, PLEASE PAY CLOSE ATTENTION TO ALL INSTRUCTIONS, WARNINGS, CAUTIONS AND NOTICES REGARDING THE USE AND CARE OF THIS PRODUCT.

Warning: THIS INDICATION ALERTS YOU TO THE FACT THAT IGNORING THE CONTENTS DESCRIBED HEREIN CAN RESULT IN POTENTIAL DEATH OR SERIOUS INJURY.

Notice: This indication alerts you to the fact that ignoring the contents described herein may negatively affect product performance and functionality.

Notice: STRICTLY OBSERVE THE FOLLOWING GUIDELINES IN ORDER TO USE THE PRODUCT PROPERLY AND AVOID POTENTIALLY DANGEROUS ACCIDENTS.

Steps

1. Read and understand all steps in the instructions before starting the installation. Park the motorcycle on a hard, level surface and turn off the ignition. Let cool.

Warning: YOU WILL BE WORKING AROUND THE ENGINE AND EXHAUST SYSTEM DURING INSTALLATION. ENSURE THAT THE ENGINE AND EXHAUST SYSTEM HAVE FULLY COOLED TO PREVENT INJURY.

2. Remove the left side driver floorboard by removing the hardware as shown in PIC 1. Set this hardware aside, will be reused.

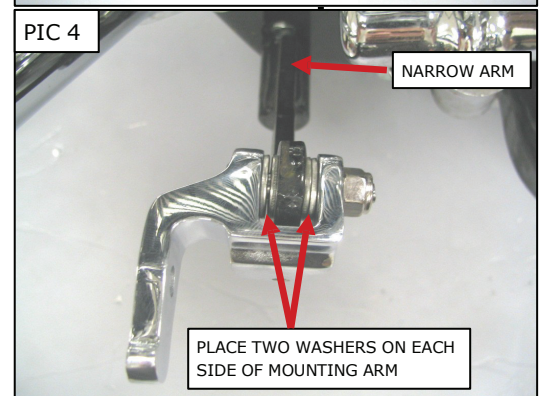
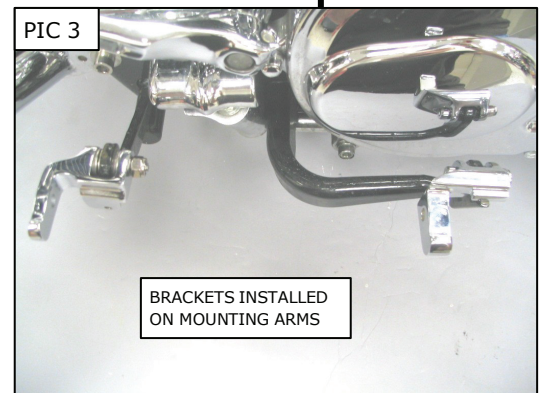
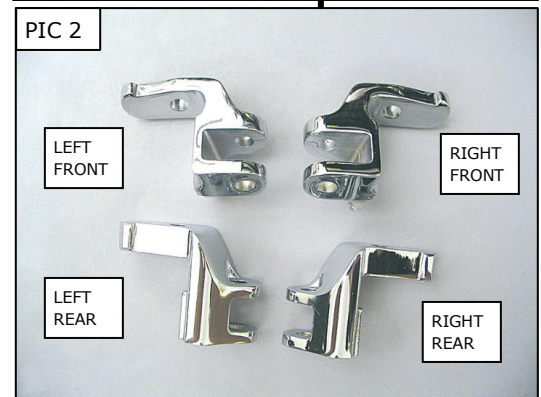
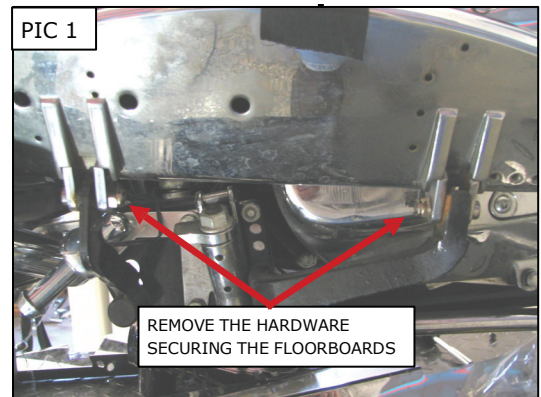

3. Refer to PIC 2 to determine the left (sitting on the bike) brackets and install the left brackets on the mounting arms on the bike. PIC 3; secure the arms with the 1/4"-20 x 1-1/4" shoulder bolts and 1/4"-20 nylon locking nuts from the hardware kit.

NOTE: On models with narrow front mounting arms you will need to install two washers on each side of the front mounting arm as shown in PIC 4.

4. Install the set screw from the hardware kit in the front bracket as shown in PIC 5, tighten the set screw until it contacts the support arm.

5. Install the floorboards on the brackets as shown in PIC 6, using the hardware that was removed in STEP 2.

6. Repeat STEP 2 through Step 5 for the right side.

Warning: THIS INDICATION ALERTS YOU TO THE FACT THAT IGNORING THE CONTENTS DESCRIBED HEREIN CAN RESULT IN POTENTIAL DEATH OR SERIOUS INJURY.

Notice: Check clearance for proper operation of controls. The Relocator Brackets provide more room to place your feet/new riding positions. Confirm clearance and relation of the position of your feet to the shifter and the brake pedals.

Notice: It is the installer's responsibility to ensure that all of the fasteners (including pre-assembled) are tightened before operation of the motorcycle.

