

**⚠ WARNING**

The rider's safety depends upon the correct installation of this kit. If the procedure is not within your capabilities or you do not have the correct tools, have a dealer perform the installation. Improper installation of this kit could result in death or serious injury.

**Kit Contents**

See Figure 1.

**INSTALLATION**

*NOTE*

1. See Figure 1. Remove the previously installed brake pedal cover from the foot brake lever.
2. Position the pad housing over the brake pedal aligning raised area under plate with oval hole in brake pedal.
3. Position washer (3) under hole of the brake pedal.

4. From top of mounting plate, install tread through pad housing, brake pedal, and washer.
5. From under brake pedal, install locknut (4) to secure pad housing and washer to brake pedal. Tighten locknut to 60-90 in-lbs (6.78-10.16 Nm).

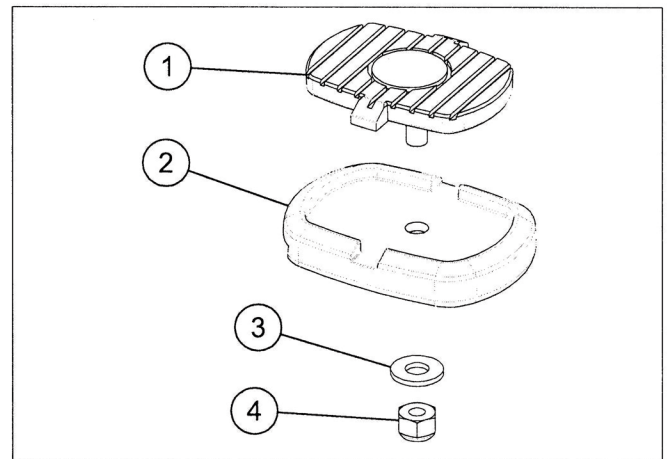

**Figure 1.**

**Contents**

Item	Description (Quantity)
1	Tread
2	Pad housing
3	Washer
4	Locknut