

VT No. 28-0825 and 28-0826

Kit Contents

See Figure 1

INSTALLATION

1. See Figure 1. Remove and discard the previously installed brake pedal cover from the foot brake lever.
2. Align the pad assembly over the foot brake pedal (3) as shown. Assemble the plain washer (4) and screw (5).
3. Thread the screw through the hole in the brake lever and into the back of the pad.
4. Tighten the screw to 10 ft-lbs (13.56 Nm).

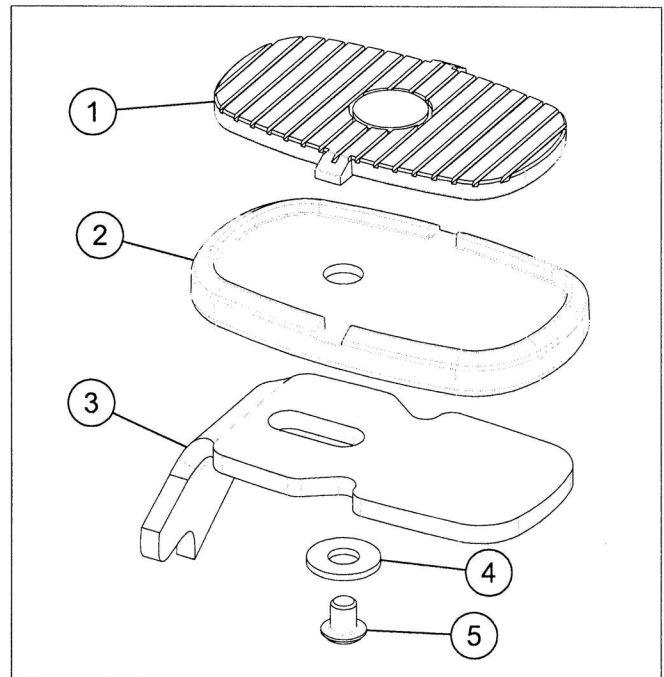

Figure 1

Item	Description (Quantity)
1	Pad
2	Pad housing
3	Brake pedal original equipment
4	Washer
5	Button head capscrew