

## GENERAL

### Kit Number

VT. 31-1543

### Kit Contents

See Figure 3 and Table 1.

## INSTALLATION

1. Follow owner's manual instructions to remove the existing seat. Remove the seat post, washer and screw from the rear fender. **Do not** remove the grommet or T-spacer. Save the washer and screw for later installation.
2. See Figure 1. Clean with a mixture of 50 percent isopropyl alcohol and 50 percent distilled water. Allow to dry completely.
3. Install the frame cover to the frame:
  - a. Remove the hook side (3) of the hook-and-loop fastener from the bottom of the frame cover (1).
  - b. Remove the liner from the adhesive backing of the hook side strip, and attach the strip to the frame as shown. Wrap the strip under the frame or trim excess length if necessary.
  - c. Position the frame cover so it covers the seat pan. Secure the cover to the frame with the hook-and-loop fastener.

## XL SPRING SEAT MOUNTING KIT

4. See Figure 3. Install each seat spring (2) to the spring saddle mounting bracket (1) as shown, with one screw (3) from the kit. Tighten the screws to 34–41 N·m (25–30 ft-lbs).
5. Install the spring saddle mounting bracket to the frame tab:
  - a. Install the mounting bracket (1) over the frame tab. Align the bracket so the two retaining tabs hold down and are fully seated on the frame cover.
  - b. Secure the mounting bracket with the original equipment (OE) screw (B) and washer (C), and one flange nut (4) from the kit. Do not fully tighten.
  - c. Center the frame cover and mounting bracket to the motorcycle frame.
  - d. Tighten the mounting bracket screw and nut to 20–27 N·m (15–20 ft-lbs).
6. Install the saddle pivot bracket (15) to the saddle with three washers (14) and screws (13). Tighten the screws to 5.5–8 N·m (48–72 in-lbs).
7. Remove the rear fuel tank mounting screw, washers, nut and thread protector. Save the washers for later installation. The remaining fasteners can be recycled or properly disposed of.

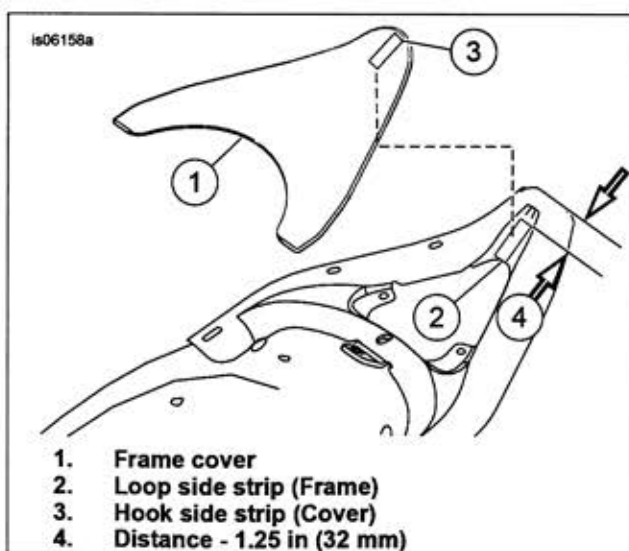
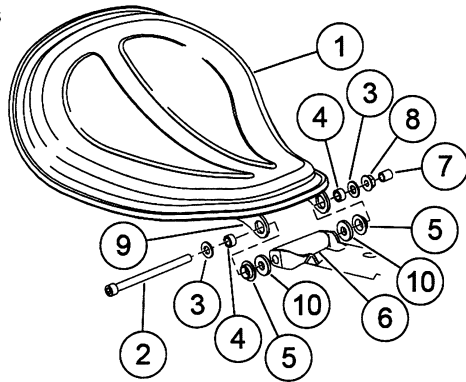

Figure 1. Secure Frame Cover to Frame

is06155



1. Saddle
2. Screw
3. Washer (2)
4. Sleeve spacer (2)
5. Bushing (2)
6. Rear fuel tank mounting point
7. Thread protector
8. Nut
9. Pivot bracket
10. Spacer (2)

Figure 2. Install Saddle and Pivot Bracket to Fuel Tank and Frame

8. See Figure 2. Install the saddle (1) and pivot bracket (9) to the frame and fuel tank:
  - a. Install bushings (5) into the pivot bracket from the inside.
  - b. Install an OE washer (3) and a sleeve spacer (4) from the kit onto screw (2). Insert the screw through the right side of the pivot bracket. Install a thin spacer (10) onto the screw threads.
  - c. Install the pivot bracket over the rear fuel tank mounting point (6).
  - d. Install a thin spacer (10) between the left side of the fuel tank mounting point and the left bushing. Slide the screw through the left side of the pivot bracket.
  - e. Secure the screw with a sleeve spacer (4), OE washer (3) and nut (8). Tighten the nut and screw to 20–27 N·m (15–20 ft-lbs).
  - f. Install the thread protector cap (7) over the screw threads.
9. See Figure 3. Secure the saddle (A) to the springs (2). **Seats with 1/2 in hole:** secure with screws (3). Tighten the screws to 34–41 N·m (25–30 ft-lbs). **Seats with 3/8 in hole:** secure with screws (17) and spacers (16). Tighten the screws to 14–16 N·m (120–144 in-lbs).
10. Complete seat installation. After installing seat, pull up on the seat to verify that it is secure.

## SERVICE PARTS

is06140c

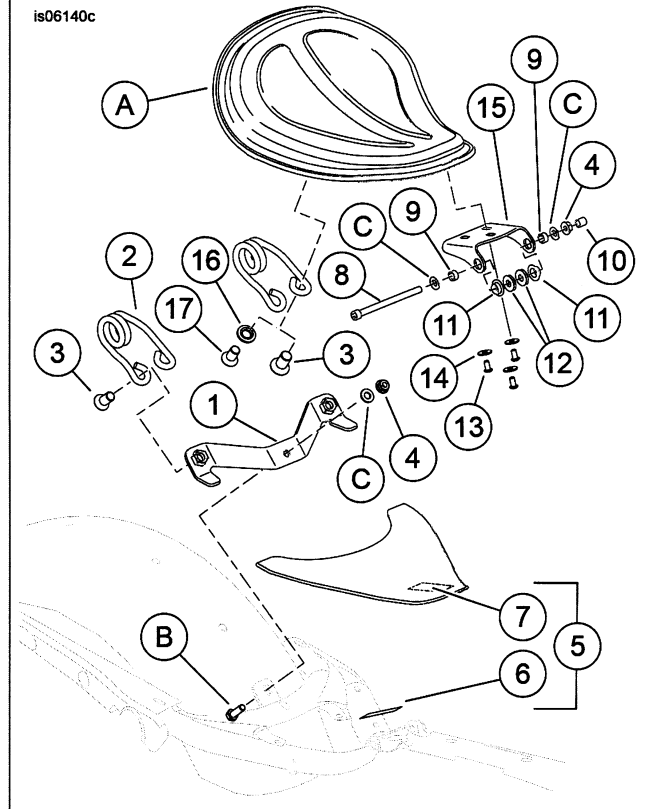

Figure 3. Service Parts: XL Spring Seat Mounting Kit

Table 1. Service Parts

Item	Description (Quantity)	Part Number
1	Spring saddle mounting bracket	Not sold separately
2	Spring, seat (2)	Not sold separately
3	Screw, 1/2, flat head (4)	Not sold separately
4	Nut, flange (2)	Not sold separately
5	Cover, frame	54078-10A
6	• Hook-and-loop, loop side	Not sold separately
7	• Hook-and-loop, hook side	Not sold separately
8	Screw, socket head	10200385
9	Spacer, sleeve (2)	Not sold separately
10	Cap, thread protector	89586-04
11	Bushing, spring saddle (2)	Not sold separately
12	Spacer, seat pivot (2)	Not sold separately
13	Screw, button head (3)	3063
14	Washer, plain (3)	6253W
15	Saddle pivot bracket	Not sold separately
16	Spacer seat support (2)	Not sold separately
17	Screw, 3/8, hex button head (2)	Not sold separately
<b>Items mentioned in text, but not included in kit.</b>		
A	Solo spring saddle	
B	OE screw	
C	OE washer (3)	