

VT No. 31-1739
DOCKING HARDWARE KIT

Tools and Supplies Required

Loctite® 243 Threadlocker and Sealant - Blue is required for the proper installation of this kit.

WARNING

Rider and passenger safety depend upon the correct installation of this kit. If the procedure is not within your capabilities or you do not have the correct tools, have a dealer perform the installation. Improper installation of this kit could result in death or serious injury.

INSTALLATION

NOTE

Perform the following procedures one side at a time to maintain fender alignment.

Front Docking Point Installation

1. See Figure 1. Remove and discard the fender support front screw.
2. Apply a few drops of Loctite 243 - Blue to the threads of a new screw (3) from the kit. Install a front docking point (2), tapered end last onto the screw threads, followed by a washer (6).
3. Install the screw to the fender, and tighten to 16–24 N·m (12–18 ft-lbs).

Rear Docking Point Installation

1. Remove and discard the fender support rear screw
2. Apply a few drops of Loctite 243 - Blue to the threads of a new screw (3) from the kit. Install a rear docking point (1), countersunk end first onto the screw threads, followed by a spacer (4).
3. Install the screw to the fender, and tighten to 16–24 N·m (12–18 ft-lbs).
firmly into place and hold in position with steady pressure for 30 seconds. Repeat for the other sideplate.

Maintenance

NOTE

In time docking points may wear, causing the mating luggage rack or sideplates to become loose and rattle. The fit may be tightened using the following procedure.

1. Mark each docking point to indicate the current top position.
2. Remove the docking hardware.
3. Thoroughly remove all existing threadlocking agent from the docking point fastener and mounting hole threads before applying new Loctite 243 - Blue to the screw threads.
4. Rotate the docking points clockwise approximately 45 degrees from the previous position.
5. Tighten the docking hardware to the torque value indicated in the installation procedures.

This procedure can be repeated up to three times before replacement of the docking points is recommended.

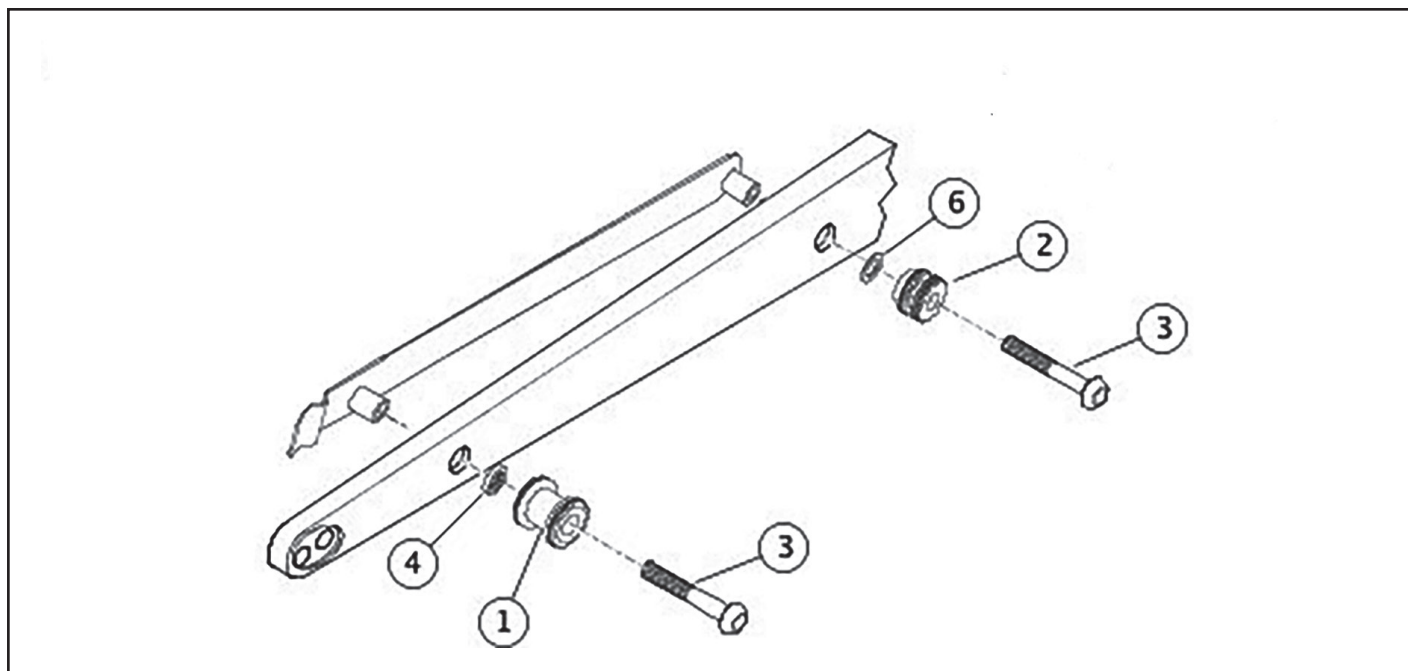

ITEM	DESCRIPTION (QUANTITY)	PART NUMBER
1	Docking point, rear (2)	31-1304
2	Docking point, front (2)	31-1301
3	Screw, button head, 3/8-16 x 1-3/4 in (4)	37-8723
4	Spacer (2)	Not Sold Separately
6	Washer (2)	37-9310