

Solo Seat Mount Kit includes seat plunger kit, seat "T", and pivot bolt.

DISASSEMBLY

See Fig. 2H -3 for order of disassembly. Bushings (19 and 20) are a press fit in seat post bushing sleeve.

INSPECTION

Before re-assembling clean and inspect all parts.

Replace any that are badly worn or damaged. Pay particular attention to bushings (19).

ASSEMBLY

Assembly is essentially the reverse order of disassembly. Bushings that have been replaced may develop high spots when driven or pressed into place. Ream to size with a 5/8 in. reamer. Apply a heavy coating of grease to seat post springs (16 and 17) before inserting in seat post. After assembly, apply grease to seat post roller shaft (13) and seat bar bolt (2) through grease fittings.

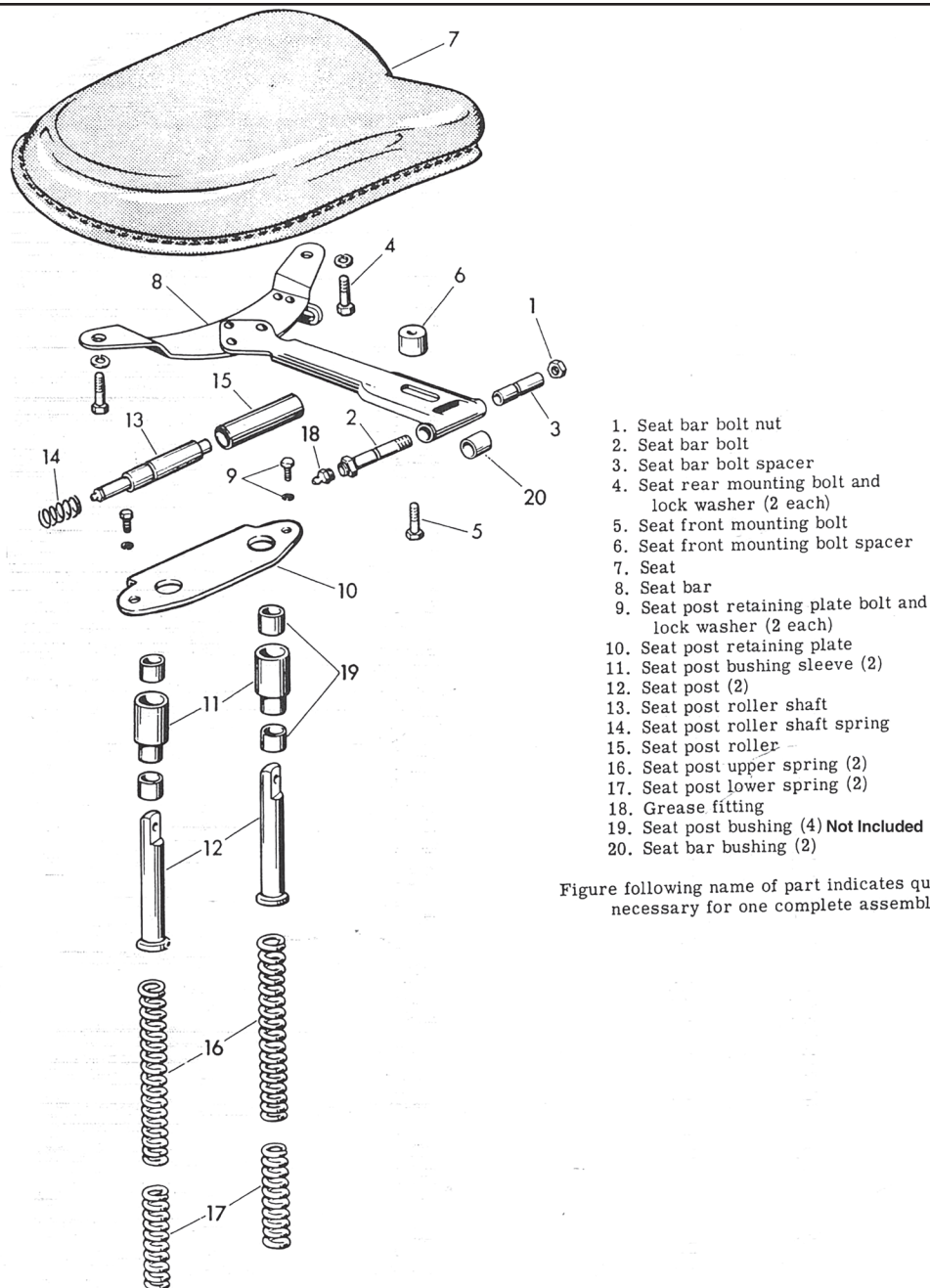

Figure following name of part indicates quantity necessary for one complete assembly.

Figure 2H-3. Seat Post and Seat - Exploded View