

INSTALLATION INSTRUCTIONS VT No. 39-0280

TACHOMETER

① MOUNTING

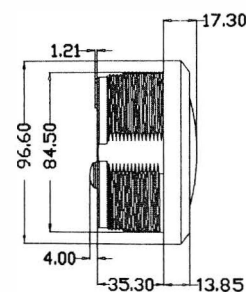
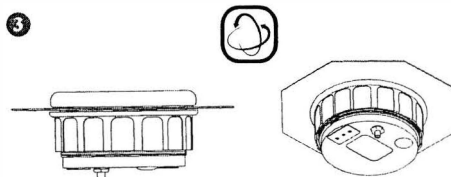
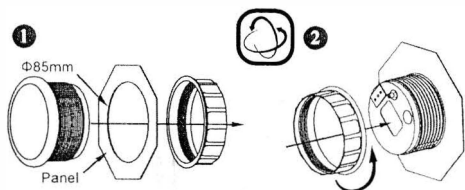

- Before installation, make sure there's enough space / depth for the gauge.
- Mount the gauge in the hole and screw down.
- Diameter: 85mm(3-3/8")
- Depth: 55mm(2-1/6")

② GAUGE WIRING

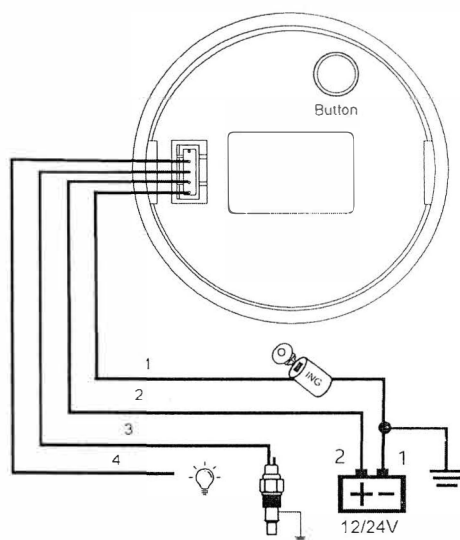

Outboard	
Poles	Speed Ratio
4	2
6	3
8	4
10	5
12	6

- 1.Black: Ground(-)
2.Red: 9-32VDC(+)
3.Blue: RPM Signal
4.Yellow: Backlight

Diesel Engine	
Gear Number	Speed Ratio
Speed Ratio = Gear Number	

Inboard Gas Engine		
Cylinder	Cycle	Speed Ratio
4	4	2
6	4	3
8	4	2 or 4
10	4	5
12	4	6

SETTING OF TACHOMETER

The minimum step value is 0.1, the adjustment range: 1.0 - 360.0

- 1.When power is on, keep on pressing the button of the backside for 3 seconds, it will enter into setting mode. If release the button over 3 seconds, it will be out of setting mode.
- 2.After enter into setting mode, press the button, the value will automatically increase. The longer you pressing the button, the quicker the value will count.
- 3.Release the button and press again, the value will automatically decrease. The longer you pressing the button, the quicker the value will count.
- 4.After get the required value, release the button. The tachometer will save your setup after 3 seconds. If the set up doesn't meet your demand, please re-setup.