

VT No. 49-1873 and 49-1874
Saddlebag Guard Rail Kit

WARNING

Rider and passenger safety depend upon the correct installation of this kit. If the procedure is not within your capabilities or you do not have the correct tools, have a dealer perform the installation. Improper installation of this kit could result in death or serious injury.

REMOVAL

1. Remove saddlebags. See owner's manual.
2. See Figure 1. Remove short screw (1) and nut (2). Discard hardware.
3. Remove long screw (4) and nut (3). Discard nut.

INSTALLATION

NOTE: Install saddlebag guard rail to one side at a time.

1. See Figure 2. Install rear guard rail to saddlebag support.
 - a. Secure saddlebag guard rail (1) with short screw (3), large lockwasher (4) and nut (5). Leave fasteners loose.
 - b. Install original equipment (OE) long screw (2) and nut (6). Leave fasteners loose.
2. Install front guard rail to saddlebag support.
 - a. Position front of saddlebag guard rail (1) onto support assembly.
 - b. Secure with clamp (7), small lockwashers (8) and screws (9).
 - c. Tighten screws (9).

Torque: 7.3 N·m (65 in-lbs) Front Clamp Screw
3. Tighten screw (2) and nut (6).
Torque: 40.7–50.2 N·m (30–37 ft-lbs) Rear Outboard Screw
4. Tighten screw (3) and nut (5).
Torque: 20.3–27.1 N·m (15–20 ft-lbs) Rear Inboard Screw
5. Repeat installation for opposite side.
6. Install saddlebags. See owner's manual.

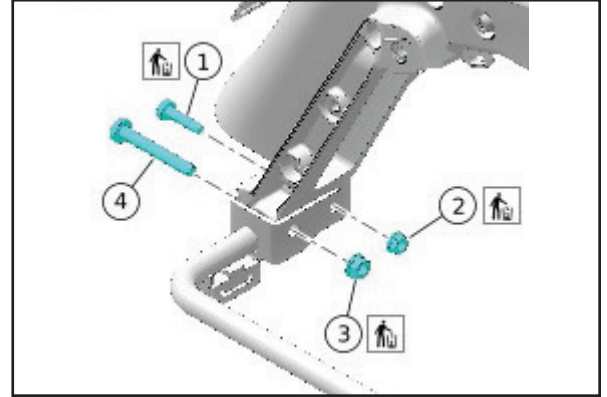

Figure 1. Hardware Removal

- | | |
|---|-------------|
| 1 | Short screw |
| 2 | Nut |
| 3 | Nut |
| 4 | Long screw |

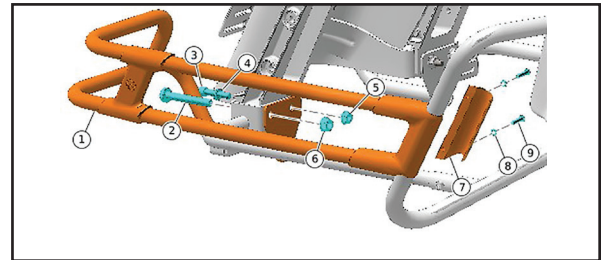

Figure 2. Saddlebag Guard Rail

- | | |
|---|----------------------|
| 1 | Saddlebag guard rail |
| 2 | Long screw |
| 3 | Short screw |
| 4 | Large lockwasher |
| 5 | Small nut |
| 6 | Large nut |
| 7 | Clamp |
| 8 | Small lockwasher (2) |
| 9 | Screw (2) |

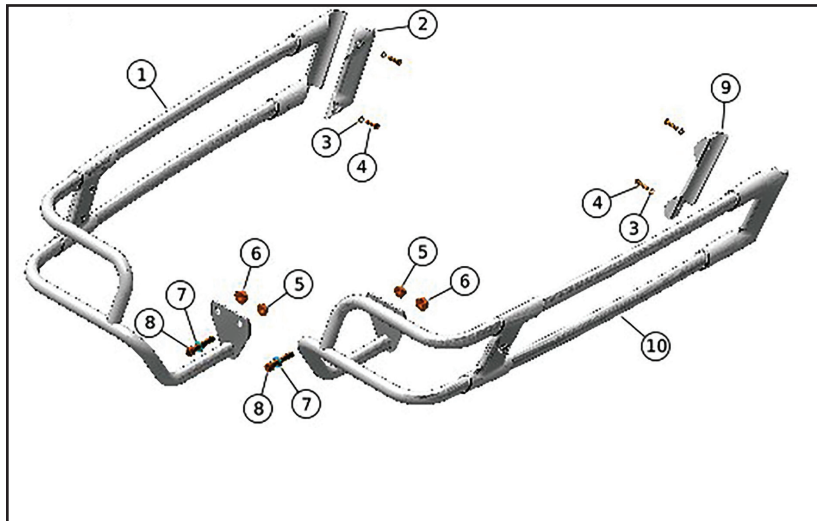

Figure 3. Service Parts: Saddlebag Guard Rail Kit

Table 1. Service Parts Table

Item	Description (Quantity)	Part Number
1	Saddlebag guard rail, left, chrome (Items included 2-8) Saddlebag guard rail, left, black (Items included 2-8)	
2	Clamp, left	
3	Lockwasher, small (4)	7069
4	Screw (4)	4846
5	Nut, small (2)	7531
6	Nut, large (2)	7601
7	Lockwasher, large (2)	94081-90T
8	Screw, short (2)	94583-98
9	Clamp, right	
10	Saddlebag guard rail, right, chrome (Items included 3-9) Saddlebag guard rail, right, black (Items included 3-9)	