

VT No. 50-1645 and 50-1644 Rigid Mount Sissy Bar Upright

WARNING

Rider and passenger safety depend upon the correct installation of this kit. If the procedure is not within your capabilities or you do not have the correct tools, have a dealer perform the installation. Improper installation of this kit could result in death or serious injury.

Kit Contents

See Figure 2 and Refer to Table 1.

PREPARE

- 1. If vehicle equipped with rigid or detachable saddlebags.
 - a. Remove screws and saddlebags.
 - b. Remove docking points.

2. NOTE

Washers should be centered on inside of the four holes.

See Figure 2. Install narrow washers (4) to backrest assembly (3).

REMOVAL

- 1. See Figure 1. Remove OEM reflector (1) from each side of fender strut.
 - a. Saw behind reflectors with mono-filament fishing line or waxed dental floss.
 - b. Use 3M GENERAL PURPOSE ADHESIVE REMOVER to remove remaining foam backing tape and adhesive from mounting surface.
 - c. Clean surface with a mixture of 50 percent isopropyl alcohol and 50 percent distilled water.
- 2. Remove screws (4) from fender (2, 3).

INSTALLATION

Without Saddlebags

NOTE

Make sure narrow washers (4) are installed prior to installation. See Prepare section.

- 1. See Figure 2. Install backrest assembly (3).
- 2. Install screws (5) from kit. Tighten.

Torque: 28–37 N·m (21–27 ft-lbs)

- a. Wait a minimum of sixty seconds for the adhesive to compress and re-tighten screws (5).

With Saddlebags

NOTE

Make sure narrow washers (4) are installed prior to installation. See Prepare section.

- 1.

NOTE

Washers should be centered on outside of the four holes.

See Figure 2. Install wide washers (6) to backrest assembly (3).

- 2. Install backrest assembly (3).
 - 3. Apply threadlocker. Install screws (5) originally removed from saddlebag or docking points. LOCTITE 243 MEDIUM STRENGTH THREADLOCKER AND SEALANT (BLUE) (99642-97)
 - 4. Tighten screws (5).
- Torque: 28–37 N·m (21–27 ft-lbs)

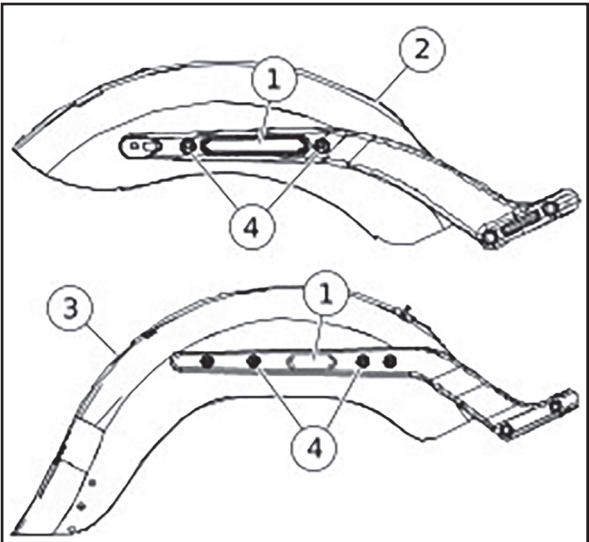

Figure 1. Fender Strut Screw

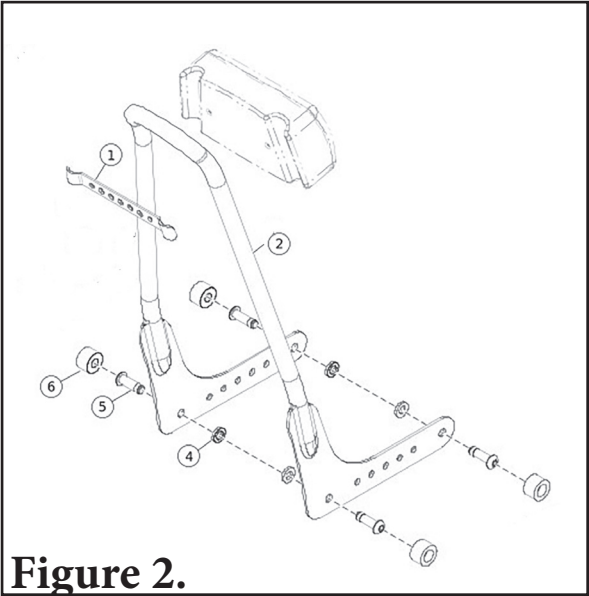

Figure 2.

ITEM	DESCRIPTION (QUANTITY)
1	Backrest support
3	Backrest assembly
4	Narrow spacer, adhesive backed (4)
5	Screw, 3/8-16 Button head Torx™ (4)
6	Wide spacer, adhesive backed (4)