

V-Twin Mfg.
CHROME LUGGAGE RACK
BOBBED FENDER
FITS 2007-UP FXST, FXSTB, FXSTC, FXSTS AND FLSTSB
Measure 11 1/2" X 6"
VT No. 50-2071

This is a custom application and rider safety depends on proper installation. This product should only be installed by a knowledgeable and trained motorcycle technician. V-Twin Mfg. accepts no responsibility for improper installation.

Installation Instructions:

1. Refer to the applicable Service Manual and remove the seat. Remove the plug from the top of the rear fender and discard.
2. Refer to the applicable Service Manual, and remove the tail light lens and bulb.
3. Place the fender rack into position as follows:
 - a. See Figure 2. Hold the carrier portion vertical, and slide the rear mounting base onto the flat license plate bracket.
 - b. Tilt the rack forward until the front mount tab is centered over the hole in the center of the fender.
 - c. Center the rear mounting base on the license plate bracket.
4. See Figure 1. Mark the position of the two rack mounting holes on the license bracket at points "A".
5. Remove the fender rack, and drill two small pilot holes in the marked locations.
6. From the underside of the license plate bracket, enlarge the two holes to 5/16 inch (8 mm) diameter.
7. a. See Figure 3. Reach from the rear and insert the seat retainer (C) into the hole in the fender from the underside, lining up the tab with the notch in the hole.
b. Install the protective tape (B) on the outside of the rear fender surrounding the hole. Place the seat tab spacer (A) over the tape.
8. See Figure 2. Position the luggage rack (1) on the license plate bracket (2) as described in Step 3.
9. See Figure 3. Lower the front mounting tab of the rack over the hole in the center of the fender. Install the chrome flat washer (6) over the front rack mounting tab.
10. Insert the chrome socket head screw (5) through the chrome washer (6) and the rack front tab. Thread the screw into the retainer, but do not tighten.
11. See Figure 3. Insert two button head screws (2) through the rear rack mounting holes and the holes in the license plate bracket. Position the flat washers (3) and nuts (4) onto the screws from the underside, and tighten to 14 in. lbs.
12. Secure the rack by tightening the front socket head mounting screw (5) to 12 ft-lbs.
13. Refer to the applicable Service Manual for proper seat installation.
14. Refer to the applicable Service Manual to re-install the bulb and taillight lens.
15. Check for proper tail lamp operation.

Parts List

Item	Description (Quantity)	Item	Description (Quantity)
1	Rack, Bobtail Fender	6	Flat washer, 1/4 in. (chrome)
2	Screw, button head, hex, 1/4-20 x 5/8 in. (Chrome) (2)	7	Seat Tab Retainer Kit
3	Flat washer, 1/4 in. (2)	A	Spacer, seat tab
4	Hex nut, 1/4-20 (2)	B	Tape, protective
5	Screw, socket head, 1/4-20 x 3/4 in. (Chrome)	C	Retainer, seat tab

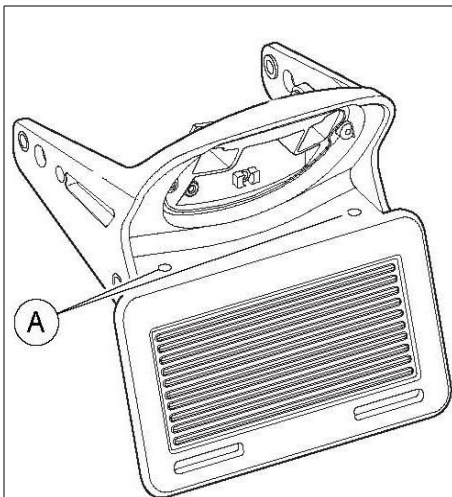

Figure 1

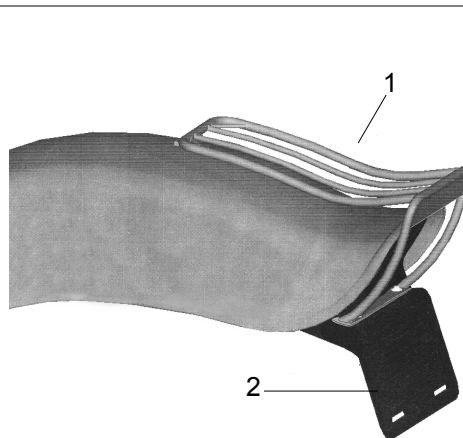

Figure 2

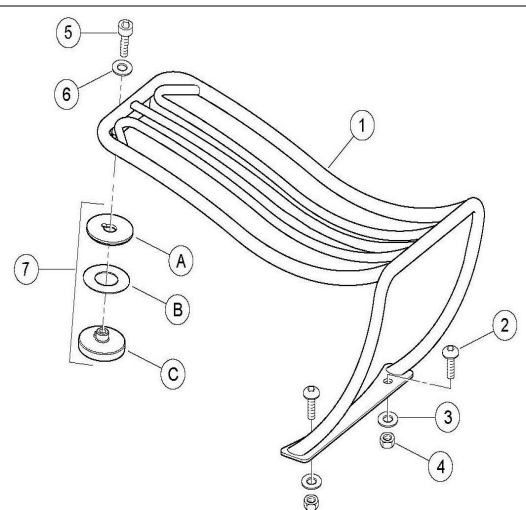

Figure 3